

**50-155
KICKSTAND
PORTABLE WORK STAND**

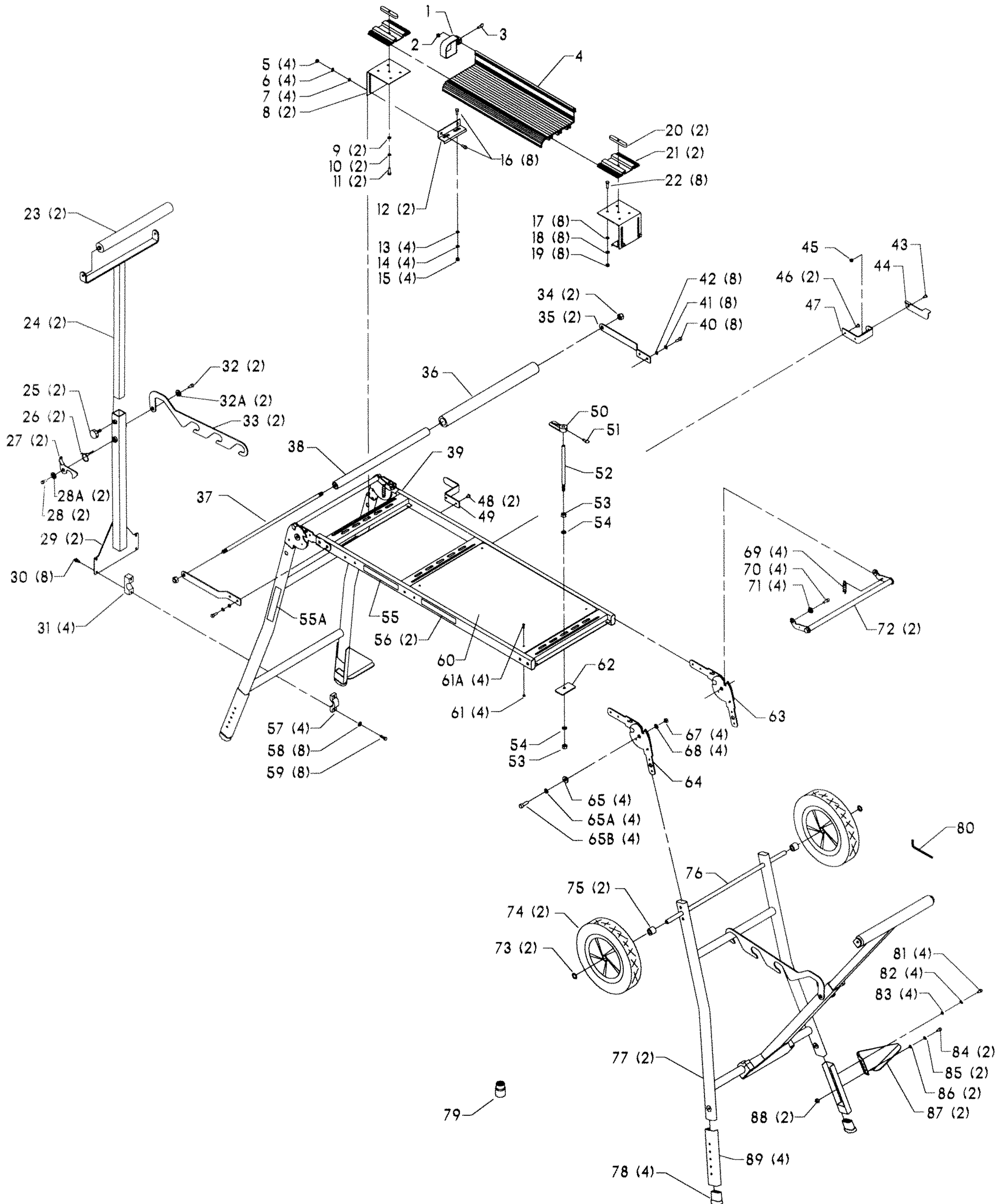

REPLACEMENT PARTS

<u>REF. NO.</u>	<u>PART NUMBER</u>	<u>DESCRIPTION</u>	<u>REF. NO.</u>	<u>PART NUMBER</u>	<u>DESCRIPTION</u>
1	1346151	STOP ASSY, <i>INCL:</i>	50	1346159	CLAMP
2	1243456	(DIN 934) M6 HEX NUT	51	1346152	(DIN 316) M6 X 12MM THUMB SCR
3	1346152	(DIN 316) M6 X 12MM THUMB SCR	52	1346160	ROD
4	1346153	FENCE	53	1243456	(DIN 934) M6 HEX NUT
5	1243456	(DIN 934) M6 HEX NUT	54	1246140	(DIN 125) M6.4 FLAT WASHER
6	1243520	(DIN 7980) M6.1 LOCK WASHER	55	1342616	NAMEPLATE
7	1246140	(DIN 125) M6.4 FLAT WASHER	55A	1342617	WARNING LABEL
8	1346154	BRACKET	56	1342615	NAMEPLATE
9	1246140	(DIN 125) M6.4 FLAT WASHER	57	1346170	CLAMP
10	1243520	(DIN 7980) M6.1 LOCK WASHER	58	1246140	(DIN 125) M6.4 FLAT WASHER
11	1246014	(DIN 933) M6 X 15MM HEX HD SCR	59	1346169	(DIN 7380) M6 X 20MM BUTTON HD SCR
12	1346155	BRACKET	60	1346168	TABLE BOARD
13	1246140	(DIN 125) M6.4 FLAT WASHER	61	1343504	(DIN 985) M5 LOCK NUT
14	1243520	(DIN 7980) M6.1 LOCK WASHER	61A	1349499	(DIN 7380) M5 X 30MM BUTTON HD SCR
15	1243456	(DIN 934) M6 HEX NUT	62	1346161	PLATE
16	1346156	(DIN 603) M6 X 12MM CARRIAGE HD SCR	63	1346185	HINGE, <i>RH, INCL:</i>
17	1246140	(DIN 125) M6.4 FLAT WASHER			(<i>SEE NOTE A</i>)
18	1243520	(DIN 7980) M6.1 LOCK WASHER	65	1346184	BUSHING
19	1243456	(DIN 934) M6 HEX NUT	65A	1243502	(DIN 125) M10 FLAT WASHER
20	1346157	KEY	65B	1346183	(DIN 7380) M10 X 25MM BUTTON HD SCR
21	1346158	PLATE	67	1341996	(DIN 985) M10 LOCK NUT
22	1246014	(DIN 933) M6 X 15MM HEX HD SCR	68	1243502	(DIN 125) M10 FLAT WASHER
23	1346177	ROLLER SUPPORT	64	1346187	HINGE, <i>LH, INCL:</i>
24	1346176	TUBE ASSY			(<i>SEE NOTE A</i>)
25	1346175	KNOB	65	1346184	BUSHING
26	1346174	SPRING	65A	1243502	(DIN 125) M10 FLAT WASHER
27	1346173	LATCH	65B	1346183	(DIN 7380) M10 X 25MM BUTTON HD SCR
28	1345859	(DIN 7380) M6 X 12MM BUTTON HD SCR	67	1341996	(DIN 985) M10 LOCK NUT
28A	1246140	(DIN 125) M6.4 FLAT WASHER	68	1243502	(DIN 125) M10 FLAT WASHER
29	1346172	TUBE ASSY	69	1346189	SPRING
30	1345859	(DIN 7380) M6 X 12MM BUTTON HD SCR	70	1345880	(DIN 7380) M6 X 16MM BUTTON HD SCR
31	1346171	BLOCK	71	1346188	BUSHING
32	1345859	(DIN 7380) M6 X 12MM BUTTON HD SCR	72	1346201	LOCK ROD
32A	1246140	(DIN 125) M6.4 FLAT WASHER	73	1346191	PUSH NUT
33	1346178	BRACKET	74	1346204	WHEEL
34	1341996	(DIN 985) M10 LOCK NUT	75	1346194	SPACER
35	1346182	STRAP	76	1346195	SHAFT
36	1346181	GRIP	77	1342619	LEG ASSY
37	1346179	ROD	78	1346197	FOOT
38	1346180	HANDLE	79	1346192	SOCKET 10MM
39	1346167	FRAME	80	432-07-101-0004	5MM HEX WRENCH
40	1246014	(DIN 933) M6 X 15MM HEX HD SCR	81	1243336	(DIN 912) M6 X 20MM HEX SOC HD SCR
41	1243520	(DIN 7980) M6.1 LOCK WASHER	82	1243520	(DIN 7980) M6.1 LOCK WASHER
42	1246140	(DIN 125) M6.4 FLAT WASHER	83	1343584	M6 FENDER WASHER
43	1346163	(DIN 7380) M8 X 16MM BUTTON HD SCR	84	1246004	(DIN 912) M6 X 16MM HEX SOC HD SCR
44	1346162	RETAINER	85	1243520	(DIN 7980) M6.1 LOCK WASHER
45	1342123	(DIN 985) M8 LOCK NUT	86	1246140	(DIN 125) M6.4 FLAT WASHER
46	1346165	(DIN 7380) M5 X 16MM BUTTON HD SCR	87	1342625	STABILIZER
47	1346164	CORD WRAP <i>RH</i>	88	1243456	(DIN 934) M6 HEX NUT
48	1346165	(DIN 7380) M5 X 16MM BUTTON HD SCR	89	1342620	LEG EXTENSION
49	1346166	CORD WRAP <i>LH</i>			

NOTE A: When ordering replacement hinges, there are two types used. The same hinge is used diagonally from corner to corner. Be certain to order the correct Part Number.

REPLACEMENT PARTS

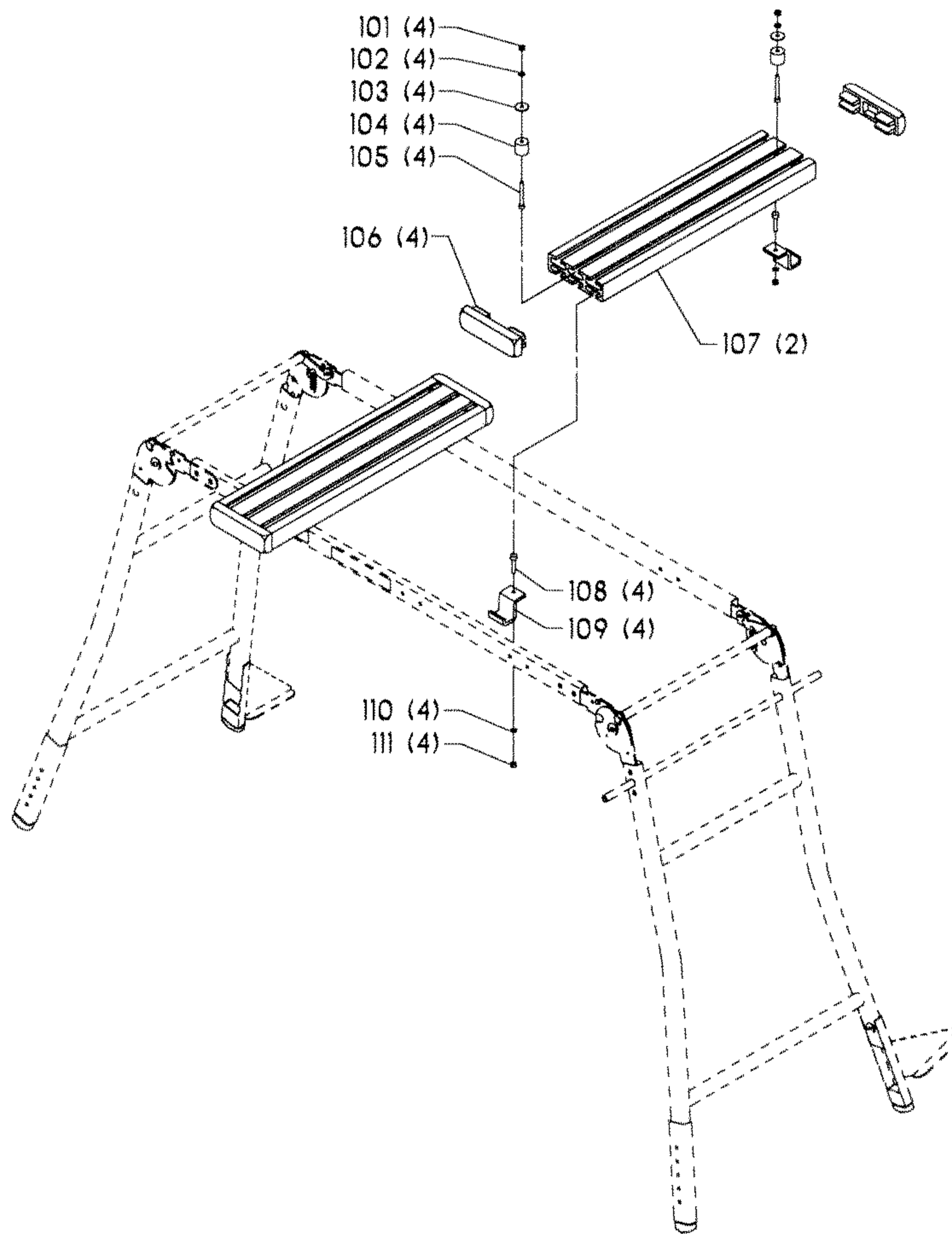

<u>REF. NO.</u>	<u>PART NUMBER</u>	<u>DESCRIPTION</u>
101	1350280	1/4-20 LOCK NUT
102	1340654	(DIN 9021) M6.4 FLAT WASHER
103	1351199	FLAT WASHER
104	1342623	SPACER
105	901-11-020-0858	1/4-20 X 2 1/4" CARRIAGE HD SCR
106	1342622	END CAP
107	1342621	MOUNTING RAIL
108	1341664	1/4-20 X 1" CARRIAGE HD SCR
109	1342624	MOUNTING CLAMP
110	904-01-031-4993	FLAT WASHER
111	1350280	1/4-20 LOCK NUT

STANDARD SAFETY EQUIPMENT

In order to promote tool safety, Delta International Machinery Corp. strictly enforces the policy of repairing or replacing any damaged or missing standard safety equipment on machines presented to Delta Authorized Service Centers for service/repair. Any product which is presented to a Delta Authorized Service Center for repairs which contains missing or damaged standard safety equipment will have that equipment repaired or replaced and the customer will be charged for any such service/repairs. Customers can avoid such charges only if the missing safety component is supplied to the service center at the time of repair.

This parts list is provided to aid in obtaining service parts. Copies of the instruction and maintenance literature can be obtained through the Delta Technical Publications Department or through your local service outlet.