

REPLACEMENT PARTS

REF. NO.	PART NUMBER	DESCRIPTION	REF. NO.	PART NUMBER	DESCRIPTION
1	901-02-120-1711	#10-32 X 3/8" TRUSS HD SCR	64	1243520	(DIN 7980) M6.1 LOCK WASHER
2	1347287	M5 PUSH NUT	65	1346716	(DIN 7985) M6 X 25MM PAN HD SCR
3	1347286	WHEEL	66	1330258	EXT RET RING
4	1347285	BUSHING	67	1347260	ARBOR LOCK PIN
5	1343504	(DIN 985) M5 LOCK NUT	68	1348261	SPRING
6	1347280	PLATE	69	1347587	RING
7	1347268	BLADE GUARD	70	400-08-139-0008	BALL BEARING
7A	1347323	LABEL	71	1347588	ARMATURE
8	1347271	GUARD MOUNT	72	1347613	(DIN 7981B) M5 X 55MM PAN HD SCR
9	1342998	SPRING	73	1343538	(DIN 7980) M5.1 LOCK WASHER
10	1343054	(DIN 603) M5 X 10MM CARRIAGE HD SCR	74	1348262	FIELD
11	1342989	ARBOR BOLT	75	400-08-139-0011	BALL BEARING
12	1347232	OUTER BLADE FLANGE	76	1343267	WAVE WASHER
13	1347267	PIVOT BOLT	77	1345470	HOUSING
14	1347289	GUARD STOP	78	1347324	MOTOR NAMEPLATE
15	1347288	SPECIAL SCR	79	1246140	(DIN 125) M6.4 FLAT WASHER
16	OPTIONAL	BLADE (SEE NOTE A)	80	1243520	(DIN 7980) M6.1 LOCK WASHER
17	1347233	INNER BLADE FLANGE	81	1347226	(DIN 7985) M6 X 35MM PAN HD SCR
18	901-01-060-0629	5/16-18 X 3/8" HEX HD SCR	82	1246008	(DIN 916) M5 X 12MM HEX SOC SET SCR
21	1347290	(DIN 7985) M6 X 35MM PAN HD SCR	83	1348263	BRUSH HOLDER
22	1243520	(DIN 7980) M6.1 LOCK WASHER	84	1348266	BRUSH
23	1347246	UPPER ARM	85	1348267	BRUSH CAP
24	1347321	NAMEPLATE	100	1347270	PLATE
26	901-02-120-7528	1/4-20 X 1/2" TRUSS HD SCR	101	1347250	STOP SCR
27	904-01-031-7709	1/4" FLAT WASHER	102	1246001	(DIN 84) M5 X 12MM CHEESE HD SCR
28	1347261	DUST SPOUT	103	1346291	WASHER
29	34-084	DUST BAG	104	1346290	SPACER
30	901-02-010-0593	#10-24 X 3/8" ROUND HD SCR	105	1347269	LINKAGE
30A	1342930	CLAMP	106	1346290	SPACER
31	1344042	(DIN 913) M5 X 20MM HEX SOC SET SCR	107	1346291	WASHER
31A	1243395	(DIN 934) M5 HEX NUT	108	901-02-453-1123	#10-32 X 1/2" PAN HD SCR
32	901-01-060-0609	5/16-18 X 1 1/2" HEX HD SCR	109	1347296	SPRING PLATE
33	1346285	SPACER	110	1347251	LOCK DOWN PIN
34	1346272	BUSHING	111	1330258	EXT RET RING
35	1347278	SPRING	112	901-04-080-0109	1/4-20 X 1 1/2" HEX SOC SET SCR
36	904-01-031-2937	FLAT WASHER	113	902-01-120-1034	1/4-20 HEX NUT
37	1342922	5/16-18 LOCK NUT	114	901-05-163-1126	#08-32 X 5/16" PAN HD SCR
38	1347266	DEFLECTOR	115	1347238	PINCH GUARD
39	901-02-010-0559	#10-32 X 1/2" ROUND HD SCR	116	1346330	CLIP
40	1346310	LH HANDLE	117	1346325	WRENCH
41	1343019	3/8" GROMMET	118	1347293	LOCK NUT
42	1345695	CORD CLAMP	119	1346288	WASHER
43	1343526	(DIN 7981B) M4.2 X 16MM PAN HD SCR	120	1341583	1/4-20 LOCK NUT
44	1343526	(DIN 7981B) M4.2 X 16MM PAN HD SCR	121	904-01-031-7709	1/4" FLAT WASHER
45	1343526	(DIN 7981B) M4.2 X 16MM PAN HD SCR	122	1346281	HANDLE
46	1346311	RH HANDLE	123	1347258	STUD
47	1343051	(DIN 7981B) M4.2 X 20MM PAN HD SCR	125	1347237	BEVEL SUPPORT
48	1246091	(DIN 84) M6 X 50MM CHEESE HD SCR	126	901-02-010-0561	#10-32 X 3/8" ROUND HD SCR
49	1346333	SWTCH	127	904-01-010-1619	FLAT WASHER
50	1310143	(DIN 85) M5 X 8MM PAN HD SCR	128	1347244	BEVEL POINTER
51	1320101	(DIN 6797A) M5.3 EXT TOOTH WASHER	129	901-04-150-1178	1/4-20 X 3/4" HEX SOC SET SCR
52	1343021	GROUND LUG	130	902-01-120-1034	1/4-20 HEX NUT
53	1346716	(DIN 7985) M6 X 25MM PAN HD SCR	131	1347236	PIVOT STUD
*	1347294	MOTOR ASSY, INCL;	138	955-03-013-1490	5/32" HEX WRENCH
60	1347295	JACKSHAFT ASSY	139	955-03-020-2167	1/8" HEX WRENCH
60A	1243520	(DIN 7980) M6.1 LOCK WASHER	140	1347283	WRENCH
60B	1347291	(DIN 7985) M6 X 12MM PAN HD SCR	141	1348270	BLACK WIRE
61	1243407	EXT RET RING	142	1348269	RED WIRE
62	1341834	BALL BEARING	144	1348268	GREEN WIRE
63	1347247	GEAR HOUSING	145	1345544	POWER CORD
			146	438-01-007-0042	WIRE NUT
			147	1347527	(DIN 7985) M4 X 10MM PAN HD SCR
			148	1320102	(DIN 6797A) M4.3 EXT TOOTH WASH

NOTE A:
 USE CROSS CUT BLADES ONLY! DO NOT USE BLADES
 DESIGNED FOR RIPPING, COMBINATION BLADES OR
 BLADES WITH EXCESSIVE HOOK ANGLES.

* NOT SHOWN ASSEMBLED

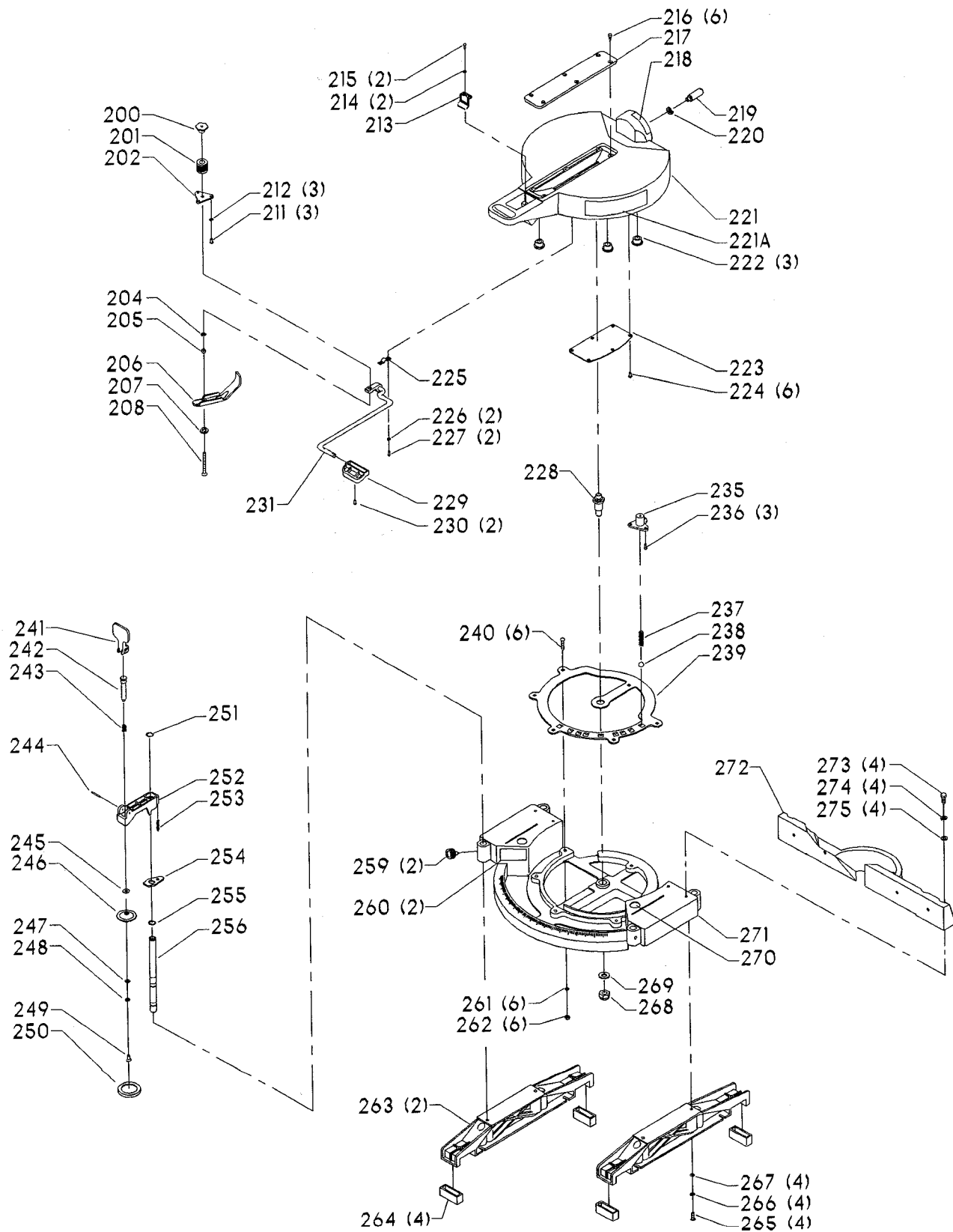

REPLACEMENT PARTS

REF. NO.	PART NUMBER	DESCRIPTION	REF. NO.	PART NUMBER	DESCRIPTION
200	1346305	RETAINER	240	901-11-020-0819	1/4-20 X 1 1/4" CARRIAGE HD SCR
201	1346306	SPRING	*	1347298	CLAMP ASSY, CONST OF;
202	1347254	PLATE	241	1346316	LEVER
204	1349163	SPECIAL WASHER	242	1347263	PLUNGER
205	1342932	1/4-20 LOCK NUT	243	1346337	SPRING
206	1347281	BRAKE STRAP	244	1246023	(DIN 1481) M4 X 28MM SPRING PIN
207	1347282	RETAINER	245	904-01-010-1603	1/4" FLAT WASHER
208	1347292	1/4-20 X 2 1/2" FLAT HD SCR	246	1342915	CUP
211	901-02-453-1123	#10-32 X 1/2" PAN HD SCR	247	904-01-010-1610	FLAT WASHER
212	904-02-020-1725	3/16" LOCK WASHER	248	904-03-030-1760	LOCK WASHER
213	1347253	MITER POINTER	249	901-02-010-0561	#10-32 X 3/8" ROUND HD SCR
214	904-01-010-1602	3/16" FLAT WASHER	250	1342944	RUBBER CAP
215	901-02-010-0561	#10-32 X 3/8" ROUND HD SCR	251	1348273	INT RET RING
216	901-02-010-0561	#10-32 X 3/8" ROUND HD SCR	252	1346319	BODY
217	1347227	BLADE INSERT	253	1346338	SPRING
218	1347265	BEVEL SCALE	254	1346318	LEVER
219	1347259	STOP STUD	255	1348273	INT RET RING
220	1243360	(DIN 7980) M10.2 LOCK WASHER	256	1346313	SHAFT
221	1347234	ROTATING TABLE	259	1347297	KNOB
221A	1347322	LABEL	260	1347326	LABEL
222	1346269	WEAR PAD	261	904-01-031-7709	1/4" FLAT WASHER
223	1347274	PLATE	262	902-01-120-1034	1/4-20 HEX NUT
224	901-02-030-0466	#08-32 X 3/8" FLAT HD SCR	263	1347228	FOOT
225	1347272	STRAP	264	1347262	FOOT
226	904-03-030-1760	LOCK WASHER	265	901-02-010-0504	1/4-20 X 3/4" ROUND HD SCR
227	901-05-163-1126	#08-32 X 5/16" PAN HD SCR	266	904-02-020-1702	1/4" LOCK WASHER
228	1347236	PIVOT STUD	267	904-01-031-7709	1/4" FLAT WASHER
229	1347256	HANDLE	268	1347293	LOCK NUT
230	901-05-743-1218	#08-32 X 1/2" FLAT HD SCR	269	1347252	WASHER
231	1347255	BAR ASSY	270	1348257	LABEL
235	1347273	DETENT HOUSING	271	1347229	BASE
236	901-03-033-1690	#10-32 X 5/8" FLAT HD SCR	272	1347239	FENCE
237	1347276	SPRING	273	901-01-060-0608	5/16-18 X 7/8" HEX HD SCR
238	1342880	STEEL BALL	274	904-02-010-1703	5/16" LOCK WASHER
239	1347230	INDEXING RING	275	1243526	(DIN 125) M8.4 FLAT WASHER

* NOT SHOWN ASSEMBLED

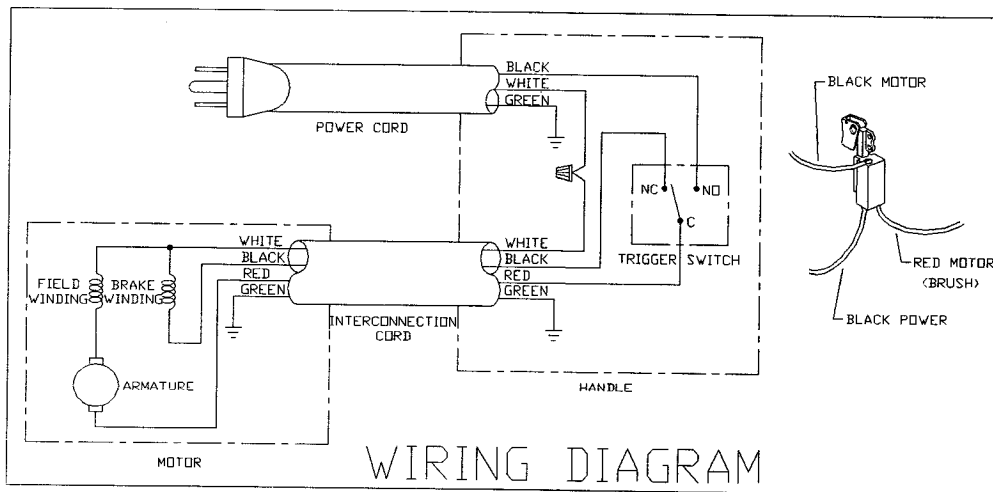

STANDARD SAFETY EQUIPMENT

In order to promote tool safety, Delta International Machinery Corp. strictly enforces the policy of repairing or replacing any damaged or missing standard safety equipment on machines presented to Delta Authorized Service Centers for service/repair. Any product which is presented to a Delta Authorized Service Center for repairs which contains missing or damaged standard safety equipment will have that equipment repaired or replaced and the customer will be charged for any such service/repairs. Customers can avoid such charges only if the missing safety component is supplied to the service center at the time of repair.

This parts list is provided to aid in obtaining service parts. Copies of the instruction and maintenance literature can be obtained through the Delta Technical Publications Department or through your local service outlet.