

REPLACEMENT PARTS

Ref. No.	Part No.	Description
1	1246018	(DIN 933) M10 x 25mm Hex Hd. Cap Scr.
2	904-02-020-1704	3/8" Lockwasher
3	1313158	Fence
4	1310196	Shim Washer
5	1310135	(DIN 963) M4 x 8mm Slot. Flat Hd. Mach. Scr.
6	1313155	Table Insert
7	1313154	Table
8	1310155	(DIN 84) M5 x 8mm Slot. Cheese Hd. Mach. Scr.
9	1313153	Scale
10	1313152	Base
11	1313151	Swivel Handle
12	1310155	(DIN 84) M5 x 8mm Slot. Cheese Hd. Mach. Scr.
13	1313145	Pointer Plate
14	1313144	Spring Plate
15	1313143	Plunger Pin
16	1313142	Spring
17	1313146	Plunger Housing
18	1313149	Pin
19	904-02-020-1702	1/4" Lockwasher
20	1246015	(DIN 933) M6 x 20mm Hex Hd. Cap Scr.
21	1313147	Plunger Handle w/Cover
22	1313148	(DIN 985) M6 Lock Nut
23	1313199	Nylon Headless Set Scr.
24	1243398	(DIN 934) M8 Hex Nut
25	904-02-010-1703	5/16" Lockwasher
26	1246016	(DIN 933) M8 x 25mm Hex Hd. Cap Scr.
27	1313141	Dowel Pin
28	1313140	Swivel Support
29	1313165	(DIN 985) M16 Lock Nut
30	1313164	(DIN 137, Form B) 16mm Wave Washer
31	1313163	Slot. Set Screw
32	1313193	M6 Shoulder Screw
33	1313194	(DIN 137, Form B) 8mm Wave Washer
34	1313150	Latch
35	1243496	(DIN 934) M10 Hex Nut
36	904-02-020-1704	3/8" Lockwasher
37	1243413	(DIN 915) M10 x 40mm Hex Soc Set Screw
38	1313159	Torsion Spring
39	1313160	Bushing
40	1246002	(DIN 84) M6 x 12mm Slot. Cheese Hd. Mach. Scr.
41	1313168	Cable Clamp
42	1313161	Upper Arm, Incl:
42A	1313208	Clip
43	904-01-010-1605	5/16" Flat Washer
44	904-02-010-1703	5/16" Lockwasher
45	1246016	(DIN 933) M8 x 25mm Hex Hd. Cap Scr.
46	1310109	(DIN 933) M16 x 130mm Hex Hd. Cap Scr.
47	1243496	(DIN 934) M10 Hex Nut
48	904-02-020-1704	3/8" Lockwasher
49	1313167	Slot Set Screw

WIRING DIAGRAM

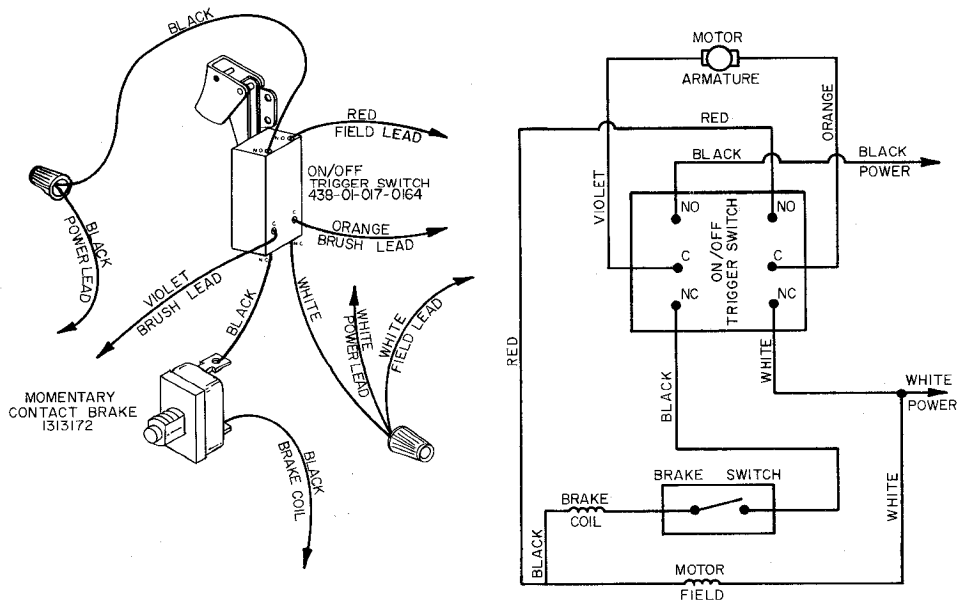

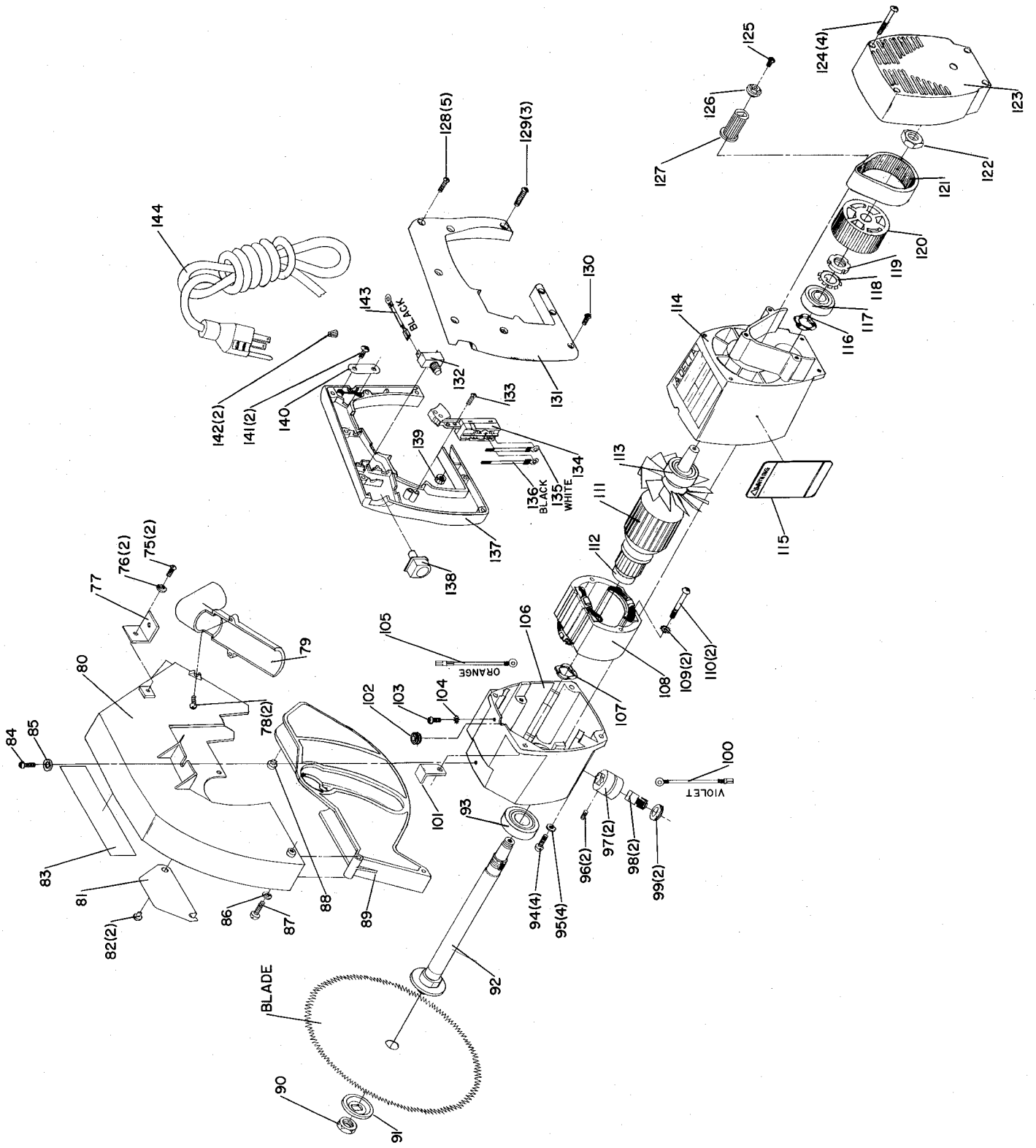

REPLACEMENT PARTS

Ref. No.	Part No.	Description
75	1246002	(DIN 84) M6 x 12mm Slot. Cheese Hd. Mach. Scr.
76	904-02-020-1702	1/4" Lockwasher
77	1313182	Bracket
78	1313180	(DIN 7513B) M5 x 12mm Slot. Pan Hd. Scr.
79	1313181	Dust Spout
80	1313370	Blade Guard Assembly, Incl:
81	1313184	Arbor Access Cover
82	1313185	Rivet
83	1313183	Nameplate
84	1246002	(DIN 84) M6 x 12mm Slot. Cheese Hd. Mach. Scr.
85	904-01-010-1604	1/4" Flat Washer
86	904-02-020-1702	1/4" Lockwasher
87	1310153	(DIN 84) M6 x 55mm Slot. Cheese Hd. Mach. Scr.
88	1313188	Rubber Bumper
89	1313189	"See Thru" Guard
90	902-01-201-8563	5/8-18 L.H. Arbor Nut
91	1313186	Arbor Flange
*	1313111	Motor Assembly, Const. of:
92	1313139	Arbor Shaft
93	1313116	Bearing
94	1310157	(DIN 85) M6 x 20mm Slot. Pan Hd. Scr.
95	904-02-020-1702	1/4" Lockwasher
96	1310172	Special Screw
97	1313112	Brush Holder
98	1313113	Brush
99	1313114	Brush Cap
100	1313133	Jumper Wire-Violet
101	1313137	L-Bracket
102	1313132	Rubber Cable Bushing
103	1310159	(DIN 85) M4 x 6mm Slot. Pan Hd. Scr.
104	1310210	(DIN 6797) A4 Ext. Tooth Lockwasher
105	1313134	Jumper Wire-Orange
106	1313117	Front Housing
107	1313118	Wave Spring Washer
108	1313138	Field Assembly
109	904-03-030-1795	3/16" Ext. Tooth Lockwasher
110	1310148	(DIN 85) M5 X 60mm Slot. Pan Hd. Scr.
111	1313125	Armature Assembly, Incl:
112	1313120	Bearing
113	1313122	Bearing
114	1313123	Rear Housing
115	1313136	Warning Label
116	1313124	Wave Spring Washer
117	1313122	Bearing
118	1313126	(DIN MB) Ø17 Lockwasher
119	1313127	(DIN KM) M3 Shaft Nut
120	1313162	Driven Pulley
121	34-083	Positive Drive Belt
122	1310188	(DIN 934) M14 Hex Nut
123	1313131	Pulley Cover
124	1310158	(DIN 85) M5 x 45mm Slot. Pan Hd. Scr.
125	1246047 1344933	(DIN 84) M5 x 16mm Slot. Pan Hd. Scr. <i>M5 x 20mm</i>
126	1313202	Special Nut
127	1313196	Drive Pulley
128	1313174	(DIN 7513B) M5 x 25mm Slot. Pan Hd. Scr.
129	1310146	(DIN 85) M5 x 30mm Slot. Pan Hd. Scr.
130	1313192	(DIN 7513B) M5 x 20mm Slot. Pan Hd. Scr.
131	1313170	Motor Handle-Right
132	1313172	Brake Switch
133	1313156	(DIN 7513B) M5 x 10mm Slot. Pan Hd. Scr.
134	438-01-628-0002	Power Switch
135	1313177	Jumper Wire-White
136	1313176	Jumper Wire-Black
137	1313169	Motor Handle-Left
138	1313171	Brake Button
139	1243395	(DIN 934) M5 Hex Nut
140	1313195	Cable Clamp
141	1313156	(DIN 7513B) M5 X 10mm Slot. Pan Hd. Scr.
142	438-01-007-0009	Wire Nut
143	1313191	Jumper Wire-Black
144	1313178	Power Cord
**	422-30-101-0002	8mm Hex Wrench
**	1313197	Arbor Wrench

* NOT SHOWN ASSEMBLED

** NOT SHOWN

This parts list is provided to aid in obtaining service parts. Operational and maintenance information is contained in a separate owner's manual which is available through your local service outlet.