

REPLACEMENT PARTS

REF. NO.	PART NO.	DESCRIPTION	REF. NO.	PART NO.	DESCRIPTION
1	428-06-031-0001	Cover	38	428-06-072-0001	Cut Limiter Plate (For Single Phase Only)
3	1246002	(DIN 84) M6 x 12mm Cheese Hd Screw	39	1246021	(DIN 963) M5 x 10mm Flat Hd Screw (For Single Phase Only)
4	428-06-133-0001	Matched Set of Three (3) V-Belts			
5	1246016	(DIN 933) M8 x 25mm Hex Hd Screw	40	1246026	(DIN 6799) 8e Retaining Ring
6	428-06-104-0001	Washer	41	428-06-111-0001	Handle Stud
7	428-06-130-0001	Cutterhead Pulley	42	428-06-067-0001	Handle
8	1246020	(DIN 933) M10 x 80mm Hex Hd Screw	43	428-06-033-0001	Crank
9	428-06-017-0001	Bushing	44	1246023	(DIN 1481) Ø4 x 28mm Roll Pin
10	428-06-130-0004	Motor Pulley (7/8" Bore, For Single Phase Motors Only)	45	428-06-017-0002	Bushing
11	1243549	(DIN 916) M6 x 12mm Hex Soc Set Screw (For Single Phase Motor Pulley Only)	46	428-06-132-0001	Scale
10	428-06-130-0003	Motor Pulley (24mm Bore, For Three Phase Motors Only)	47	1246000	(DIN 84) M3 x 6mm Cheese Hd Screw
11	1246009	(DIN 916) M8 x 10mm Hex Soc Set Screw (For Three Phase Motor Pulley Only)	48	428-06-030-0002	Column (Right Front)
12	428-06-104-0004	Flat Washer	49	1246004	(DIN 912) M6 x 16mm Soc Hd Screw
13	1246018	(DIN 933) M10 x 25mm Hex Hd Screw	50	428-06-079-0001	Rivet
14	1246029	(DIN 933) M10 x 40mm Hex Hd Screw	51	428-06-137-0001	Nameplate
15	428-06-089-0001	Motor Support	52	428-06-079-0002	Spindle Nut
16	62-175	Motor - 220V, 1Ø, 60 Hz. Incl:	53	428-06-085-0001	Small Spindle
17	438-01-628-0004	Switch	54	428-06-085-0002	Large Spindle
**	438-02-314-1026	Motor - 200-220/440V, 3Ø, 60 Hz.	55	428-06-079-0003	Key
18	428-06-072-0002	Motor Plate	56	1246093	(DIN 933) M8 x 35mm Hex Hd Screw
19	1246017	(DIN 933) M8 x 30mm Hex Hd Screw (For Single Phase Models Only)	57	1246157	(DIN 7980) Ø8mm Lockwasher
19	1246079	(DIN 933) M8 x 40mm Hex Hd Screw (For Three Phase Models Only)	58	428-06-104-0003	Spindle Washer
20	1243526	(DIN 125) Ø8mm Flat Washer	59	920-04-012-4029	Bearing
21	1243398	(DIN 934) M8 Hex Nut	60	1243505	(DIN 472) 42i Internal Retaining Ring
22	428-06-020-0001	Column Cap	61	428-06-134-0001	Sprocket
23	428-06-030-0001	Column	62	428-06-104-0004	Washer
24	428-06-088-0001	Limiter Ring	63	1243496	(DIN 934) M10 Hex Nut
25	428-06-005-0002	Head Casting	64	428-06-134-0002	Sprocket
26	428-06-075-0001	Pointer	65	428-06-104-0002	Washer
27	422-28-079-0015	Rivet	66	1246013	(DIN 933) M6 x 12mm Hex Hd Screw
28	426-06-036-0001	Chip Deflector	67	428-06-084-0001	Idler
29	1246130	(DIN 84) M6 x 16mm Cheese Hd Screw	68	428-07-104-0010	Flat Washer
30	1246006	(DIN 912) M8 x 50mm Soc Hd Screw	69	1246016	(DIN 933) M8 x 25mm Hex Hd Screw
31	428-06-112-0001	Adjusting Nut	70	428-06-023-0001	Chain (128 Pitches), Incl:
32	1246084	(DIN 916) M8 x 18mm Hex Soc Set Screw	71	428-06-023-0004	Master Link
33	1246013	(DIN 933) M6 x 12mm Hex Hd Screw	72	428-06-091-0001	Table
34	428-06-122-0001	Chipbreaker Spring	73	1246012	(DIN 916) M10 x 30mm Hex Soc Set Screw
35	428-06-014-0001	Bracket (Three Phase Only)	74	428-06-005-0003	Base
36	1246001	(DIN 84) M5 x 12mm Cheese Hd Screw (Three Phase Only)	77	1243526	(DIN 125) Ø8mm Flat Washer
37	1246010	(DIN 916) M8 x 15mm Hex Soc Set Screw	78	1243398	(DIN 934) M8 Hex Nut
			**	438-01-016-0166	Complete Motor Starter
			**	NOT SHOWN	

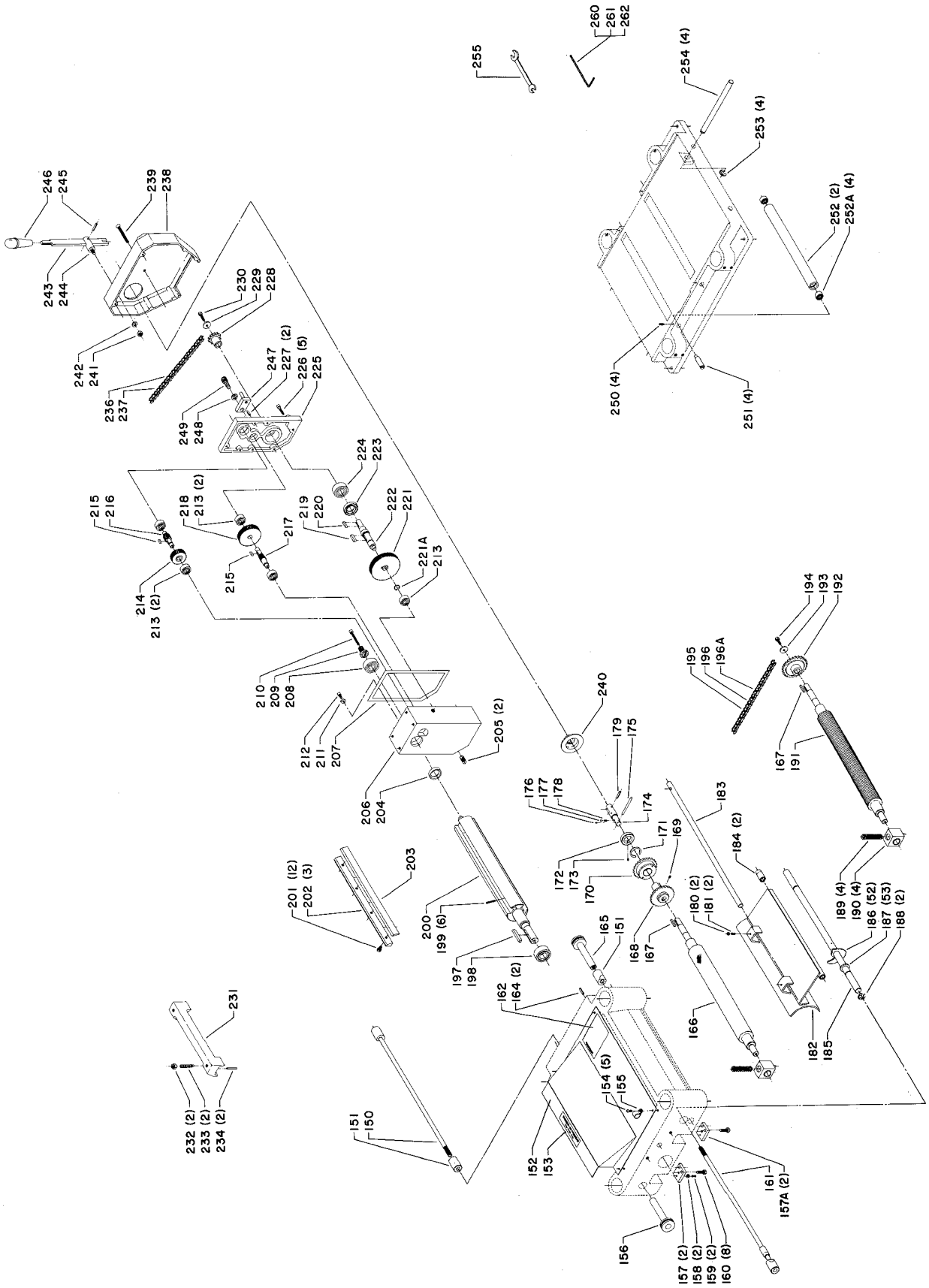

REPLACEMENT PARTS

REF. NO.	PART NO.	DESCRIPTION	REF. NO.	PART NO.	DESCRIPTION
150	428-06-004-0003	Rear Lock Bar	*	428-06-357-0001	Cutterhead Assy, w/Gear Box, Const. of:
151	428-06-017-0003	Lock Bushing	198	920-04-022-4020	Bearing
152	428-06-031-0002	Upper Cover	199	428-06-122-0003	Spring
153	1085187	Warning Label	200	428-06-012-0001	Cutterhead
154	1246045	(DIN 84) M6 x 10 Cheese Hd Screw	201	428-06-112-0003	Screw
155	438-01-004-0042	Cable Clamp	202	428-06-004-0002	Knife Locking Bar
156	428-06-138-0001	Left Locking Knob	203	22-657	Set of Three Knives
157	428-06-072-0004	Rear Plate	204	428-06-116-0001	Seal
157A	1330711	Front Plate	205	906-00-000-2436	Plug
158	1243395	(DIN 934) M5 Hex Nut	206	428-06-013-0001	Gear Box
159	1246158	(DIN 913) M5 x 16mm Hex Soc Set Screw	207	428-06-116-0002	Gasket
160	1246054	(DIN 912) M8 x 20mm Soc Hd Screw	208	920-04-020-5348	Bearing
161	428-06-004-0001	Front Lock Bar	209	428-06-051-0001	Gear
162	428-01-754-0001	Warning Label	210	1246005	(DIN 912) M6 x 45mm Soc Hd Screw
164	1246024	(DIN 1481) Ø6 x 20mm Roll Pin	211	428-06-104-0008	Flat Washer
165	428-06-138-0002	Right Locking Knob	212	1243379	(DIN 912) M6 x 10mm Soc Hd Screw
166	428-06-080-0001	Outfeed Roller	213	920-04-013-1045	Bearing
167	428-06-079-0004	Key	214	428-06-051-0002	Gear (46 Teeth)
168	428-06-134-0006	Sprocket (Fixed)	215	428-06-079-0006	Key
169	1246092	(DIN 914) M6 x 6mm Hex Soc Set Screw	216	428-06-051-0003	Gear (18 Teeth)
170	428-06-134-0007	Sprocket (Sliding)	217	428-06-051-0005	Gear (18 Teeth)
171	1243370	(DIN 471) 30e External Retaining Ring	218	428-06-051-0004	Gear (71 Teeth)
172	428-06-088-0002	Ring	219	428-06-079-0008	Key
173	1246159	(DIN 914) M5 x 5mm Hex Soc Set Screw	220	428-06-079-0004	Key
174	428-06-014-0002	Shifter Bracket, Incl:	221	428-06-051-0007	Gear (96 Teeth)
175	428-06-071-0003	Pin	221A	1246026	(DIN 6799) RS8 Retaining Ring
176	1246159	(DIN 914) M5 x 5mm Hex Soc Set Screw	222	428-06-106-0005	Shaft
177	1243446	(DIN 5401) Ø6mm Ball	223	428-06-116-0003	Seal
178	428-06-122-0004	Spring	224	920-04-020-5348	Bearing
179	1246110	(DIN 1481) Ø6 x 24mm Roll Pin	225	428-06-031-0005	Gear Box Cover
180	1243395	(DIN 934) M5 Hex Nut	226	1243336	(DIN 912) M6 x 20mm Soc Hd Screw
181	1246158	(DIN 913) M5 x 16mm Hex Soc Set Screw	227	1246025	(DIN 1481) Ø6 x 30mm Roll Pin
182	428-06-036-0002	Chipbreaker w/Bushing	228	428-06-134-0005	Sprocket
183	428-06-106-0001	Chipbreaker Adjusting Rod	229	428-06-104-0002	Washer
184	428-06-020-0002	Bushing	230	1246015	(DIN 933) M6 x 20mm Hex Hd Screw
185	428-06-106-0002	Anti-Kick Shaft	231	1330390	Gage Assembly, Incl:
186	428-06-047-0001	Anti-Kick Finger	232	1243496	(DIN 934) M10 Hex Nut (Early Models Only)
187	428-06-104-0006	Spacer	233	428-06-112-0005	Special Screw (Early Models Only)
188	1246028	(DIN 6799) 15e External Retaining Ring	234	1246023	(DIN 1491) Ø4 x 28mm Roll Pin
189	428-06-122-0002	Spring	236	428-06-023-0003	Drive Chain (46 Pitches), Incl:
190	428-06-010-0002	Block w/Bushing & Roll Pin	237	1243660	Master Link
191	428-06-080-0002	Infeed Roller	238	428-06-031-0006	Cover
192	428-06-134-0004	Sprocket	239	1246107	(DIN 963) M8 x 50mm Flat Hd Screw
193	428-06-104-0002	Washer	240	428-06-031-0007	Rubber Cover
194	1246014	(DIN 933) M6 x 15mm Hex Hd Screw	241	1243496	(DIN 934) M10 Hex Nut
195	428-06-023-0002	Feed Chain (59 Pitches), Incl:	242	1243360	(DIN 7980) Ø10mm Lockwasher
196	428-06-023-0005	Offset Link	243	428-06-067-0002	Shifter Lever
196A	1243660	Master Link	244	428-06-014-0003	Lever Bracket
197	428-06-079-0005	Key	245	1246110	(DIN 1481) Ø6mm Roll Pin
			246	428-07-138-0005	Knob
			247	428-06-080-0004	Chain Tightener
			248	904-01-010-1605	5/16" Flat Washer
			249	1246122	(DIN 912) M8 x 15mm Soc Hd Screw
			250	1243549	(DIN 916) M6 x 12mm Hex Soc Set Screw
			251	428-06-071-0001	Table Roller Pin
			252	428-06-080-0003	Table Roller
			252A	428-06-017-0004	Bearing
			253	1246027	(DIN 6799) RS12 External Retaining Ring
			254	428-06-071-0002	Lifting Handle
			255	428-06-101-0001	Wrench
			260	428-06-101-0003	2.5mm Hex Wrench
			261	428-06-101-0002	3mm Hex Wrench
			262	428-07-101-0002	6mm Hex Wrench

AVAILABLE AS ACCESSORIES

**	22-658	Shaving Hood, Incl:
**	1246034	(DIN 933) M8 x 20mm Hex Hd Screw
**	422-30-079-0006	Washer
**	50-315	Steel Stand
*	NOT SHOWN ASSEMBLED	
**	NOT SHOWN	

This parts list is provided to aid in obtaining service parts. Operational and maintenance information is contained in a separate owner's manual which is available through your local service outlet.