

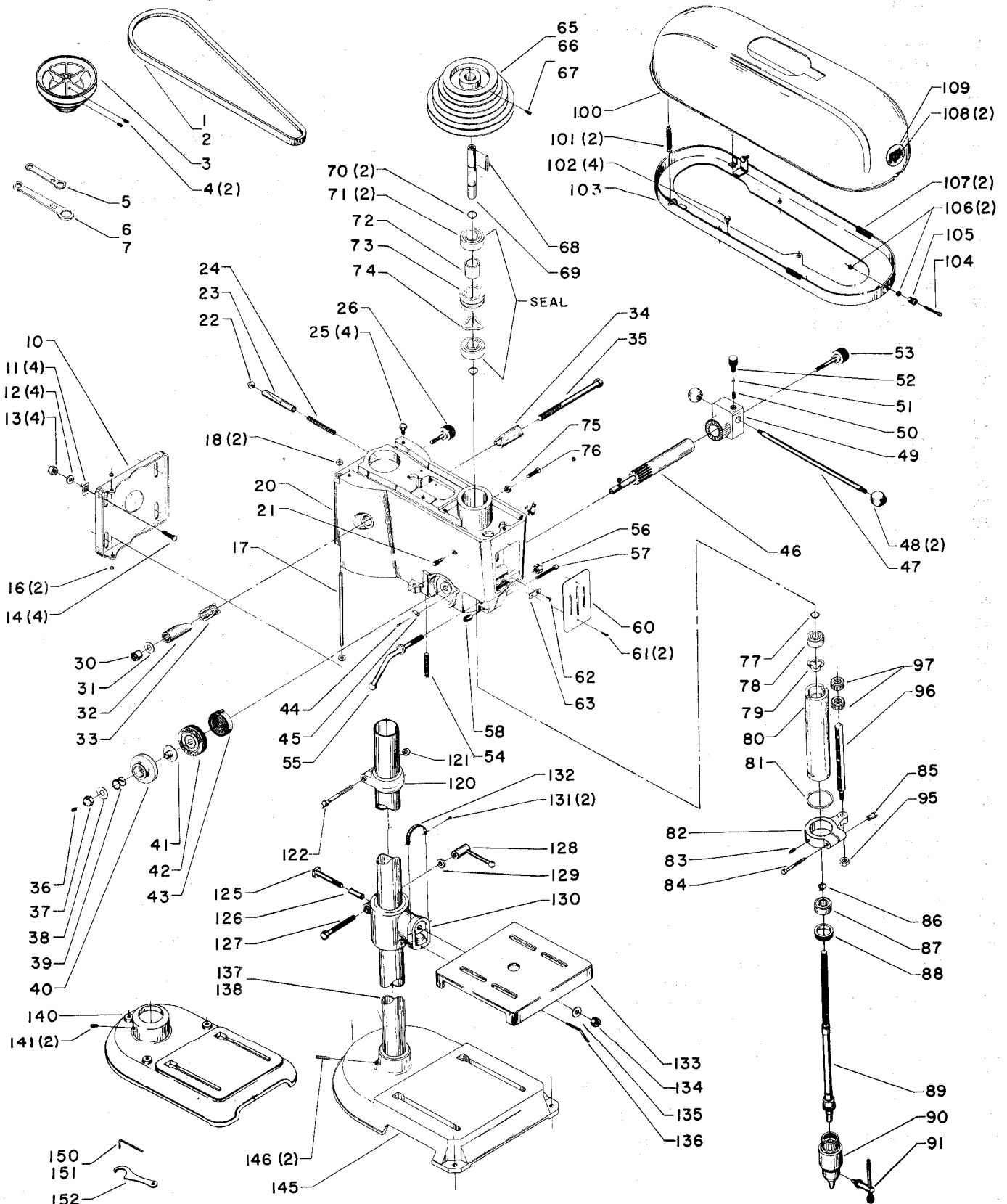

15" DRILL PRESS (old style, 4 Speed, 4 5/16" Travel, with DP-500 Head Casting)

DP-5
Revised 3-15-85

15-005, 15-006, 15-007, 15-008, 15-205, 15-206, 15-207, 15-208,
15-210, 15-211, 15-212, 15-213, 15-305, 15-306, 15-307, 15-308,
15-405, 15-406, 15-407, 15-408, 15-410, 15-411, 15-412, 15-413,
15-415, 15-416, 15-417, 15-418, 15-420, 15-421, 15-422, 15-423,
15-425, 15-426, 15-427, 15-428



Replacement Parts

Ref. No.	Part No.	Description	Ref. No.	Part No.	Description
1	49-167	Slo-Speed Belt	69	402-04-105-5001	Sleeve
2	49-168	Hi-Speed Belt	70	904-15-010-7025	Retaining Ring
3	41-702	1/2" Bore Motor Pulley, Incl:	71	920-04-020-5360	Bearing
4	901-04-190-0201	5/16-18 x 5/16" Soc. Set Scr.	72	402-04-104-5001	Bearing Spacer
3	41-703	5/8" Bore Motor Pulley, Incl:	73	402-04-079-5001	Retainer
4	901-04-150-1185	1/4-20 x 5/16" Soc. Set Scr. (1)	74	928-06-010-7352	Spring Washer
3	41-704	3/4" Bore Motor Pulley, Incl:	75	902-01-020-5435	5/16-18 Hex Nut
4	901-04-190-0201	5/16-18 x 5/16" Soc. Set Scr.	76	901-04-010-0378	5/16-18 x 7/8 Sq. Hd. Set Scr.
5	40-526	Wrench	77	904-15-010-7411	Retaining Ring
6	43-524	Wrench	78	920-04-020-5384	Bearing
7	Cannot Furnish	Wrench	79	928-06-011-4127	Spring Washer
10	402-04-072-5001	Motor Plate	80	402-04-077-5001	Quill
11	902-03-000-2951	Speed Nut	81	908-00-000-3769	Special Gasket
12	904-01-010-1620	11/32 x 11/16 x 1/16" Washer	82	402-04-314-5007	Stop Collar, Incl:
13	902-01-010-1300	5/16-18 Hex Nut	83	901-04-090-0112	#10-32 x 1/2" Hdless Set Scr.
14	901-11-020-0834	5/16-18 x 3/4" Car. Bolt	84	901-01-060-0622	1/4-20 x 2" Hex Hd. Scr.
16	904-15-010-7035	Retaining Ring	85	931-02-141-4087	1/4-20 Special Nut
17	402-04-071-5001	Pin	86	904-15-010-7410	Retaining Ring
18	904-01-031-2945	Washer	87	920-04-020-5384	Bearing
20	402-04-057-5001	Head Casting	88	902-07-020-7176	Bearing Nut
21	907-01-050-5239	Oiler	89	402-04-385-5001	Spindle
22	931-01-000-2851	Bumper	90	15-830	Chuck, Incl:
23	402-04-088-5004	Motor Plate Plunger	91	955-03-081-3708	Key
24	928-01-021-4110	Spring	95	902-01-040-1005	3/8-16 Hex Nut
25	901-01-060-0629	5/16-18 x 3/8" Hex Hd. Cap Scr.	96	402-04-108-5003	Stop Rod
26	931-03-991-9032	Knob Assembly	97	402-12-068-5001	Nut
30	902-01-010-1282	1/2-13 Hex Nut	100	15-825	Belt Guard Incl:
31	904-01-031-2905	33/64 x 7/8 x 1/16" Washer	101	928-02-011-4109	Spring
32	402-03-105-5003	Clamp Sleeve	102	901-01-060-0629	5/16-18 x 3/8" Hex Hd. Cap Scr.
33	402-03-027-5002	Column Clamp	103	402-04-354-5005	Guard Pan, Incl:
34	402-03-105-5001	Sleeve	104	901-02-050-0732	#10-32 x 1-1/4" Fil. Hd. Screw
35	901-01-060-0621	1/2-13 x 5-1/2" Hex Hd. Scr.	105	931-02-051-4074	Lock Knob
36	Cannot Furnish	1/4-20 x 3/4" Soc. Set Scr.	106	902-01-120-1203	#10-32 Hex Nut
37	902-09-040-5918	1/2-20 Acorn Nut	107	402-04-016-5001	Rubber Bumper
38	904-01-021-3570	Washer	108	901-06-450-2250	#4 x 3/16" Drive Scr.
39	928-01-041-4113	Spring	109	960-02-010-1861	Nameplate
40	402-04-037-5001	Depth Dial	120	15-010	Support Ass'y, Incl:
41	Cannot Furnish	Depth Dial Bushing	121	902-01-040-1004	7/16-14 Hex Nut
42	402-04-031-5001	Clock Spring Housing	122	901-01-060-0641	7/16-14 x 3-1/2" Hex Hd. Scr.
43	928-08-011-8868	Pinion Clock Spring	*	402-04-391-5001	Table Complete, Const. of:
44	901-06-120-3015	#6-32 x 1/4" Self Tap. Scr.	125	901-11-010-7862	1/2-13 x 2-3/4" Sq. Hd. Bolt
45	402-04-075-5001	Depth Dial Pointer	126	402-04-105-5005	Sleeve
46	402-04-106-5002	Pinion Shaft	127	901-01-060-0618	1/2-13 x 3-1/2" Hex Hd. Scr.
47	402-05-108-5004	Hand Lever	128	931-04-991-3461	Lock Bolt
48	931-01-011-3519	Hand Lever Ball	129	904-10-031-3893	Special Washer
49	402-04-409-5002	Hob For Pinion Shaft, Incl:	130	402-04-314-5002	Bracket Ass'y, Incl:
50	928-01-021-3378	Spring	131	901-06-450-2849	#6 x 1/4" Drive Scr.
51	921-01-010-0028	1/4" Steel Ball	132	402-04-072-5002	Scale
52	931-02-121-4081	Lock Knob	133	402-04-091-5001	Table
53	931-03-991-9031	Knob Assembly	134	902-01-100-1028	1/2-13 Hex Nut
54	402-04-112-5001	Adjusting Scr.	135	904-01-010-1636	17/32 x 1-1/16" x .095" Washer
55	931-04-051-4071	Ball Crank	136	402-04-071-5001	Index Pin
56	902-01-010-1232	7/16-20 Hex Nut	137	15-804	Column (Bench Model)
57	901-02-050-0703	1/4-20 x 1-3/4" Fil Hd. Scr.	138	15-806	Column (Floor Model)
58	902-01-200-9706	1/4-20 Hex Nut	140	402-04-005-5001	Base (Bench Model)
60	402-04-031-5002	Switch Opening Cover	141	901-04-150-1107	5/16-18 x 1" Soc. Set Scr.
61	901-06-120-3015	#6 x 1/4" Self Tap. Scr.	145	402-04-005-5006	Base (Floor Model)
62	901-06-120-3016	#6 x 7/16" Self Tap. Scr.	146	901-04-150-1112	3/16-18 x 1/2" Soc. Hd. Set Ser.
63	438-01-021-0081	Switch Bracket	150	48273	1/8" Hex Soc. Wrench
65	926-04-991-2323	Slo-Speed Pulley, Incl.:	151	48275	5/32" Hex Soc. Wrench
67	901-04-150-0206	5/16-18 x 5/16" Soc. Set Scr.	152	15-838	Spanner Wrench
66	926-04-991-2322	Hi-Speed Pulley, Incl:			
67	901-04-150-0206	5/16-18 x 5/16" Soc. Set Scr.			
68	927-03-010-2668	3/16 x 3/16 x 1-3/4" Key			

* Not Shown Assembled