

Replacement Parts

Ref. No.	Part No.	Description	Ref. No.	Part No.	Description
1	1230605	Tube	*	1231024	Tool Rest Base Ass'y, Incl:
2	1230615	Tube Clamp	14	1231012	Tool Rest Base
3	901-01-060-0617	3/8-16 X 1-1/2" HHS	15	904-10-031-2093	Special Washer
4	904-01-010-1605	Washer	16	901-01-060-0604	3/8-16 X 2-1/4" HHS
5	1231016	Headstock	17	901-01-060-0642	3/8-16 X 1" HHS
6	1231010	Cover Plate	18	1231021	10" Tool Rest
7	46-352	Spur Center	19	1231014	Tailstock
8	1230626	Spindle Ass'y.	20	905-01-010-6709	3/32 X 3/8" Roll Pin
9	1230676	Headstock Pulley, Incl:	21	46-345	Cup Center
10	901-04-150-0206	5/16-18 X 5/16" SSS	22	1230623	Tailstock Spindle
11	901-02-010-0515	5/16-18 X 1-1/4" RHS	23	1230624	Tailstock Handwheel
12	904-02-010-1703	5/16" Split Lockwasher	24	901-01-060-3102	3/8-16 X 1-3/4" HHS
13	1230384	Hand Knob	25	1231008	Rear Tube Bracket
			26	901-04-260-1501	1/4-20 X 1/2" Thumb Scr.
			27	1230627	Wrench
			*	NOT SHOWN	

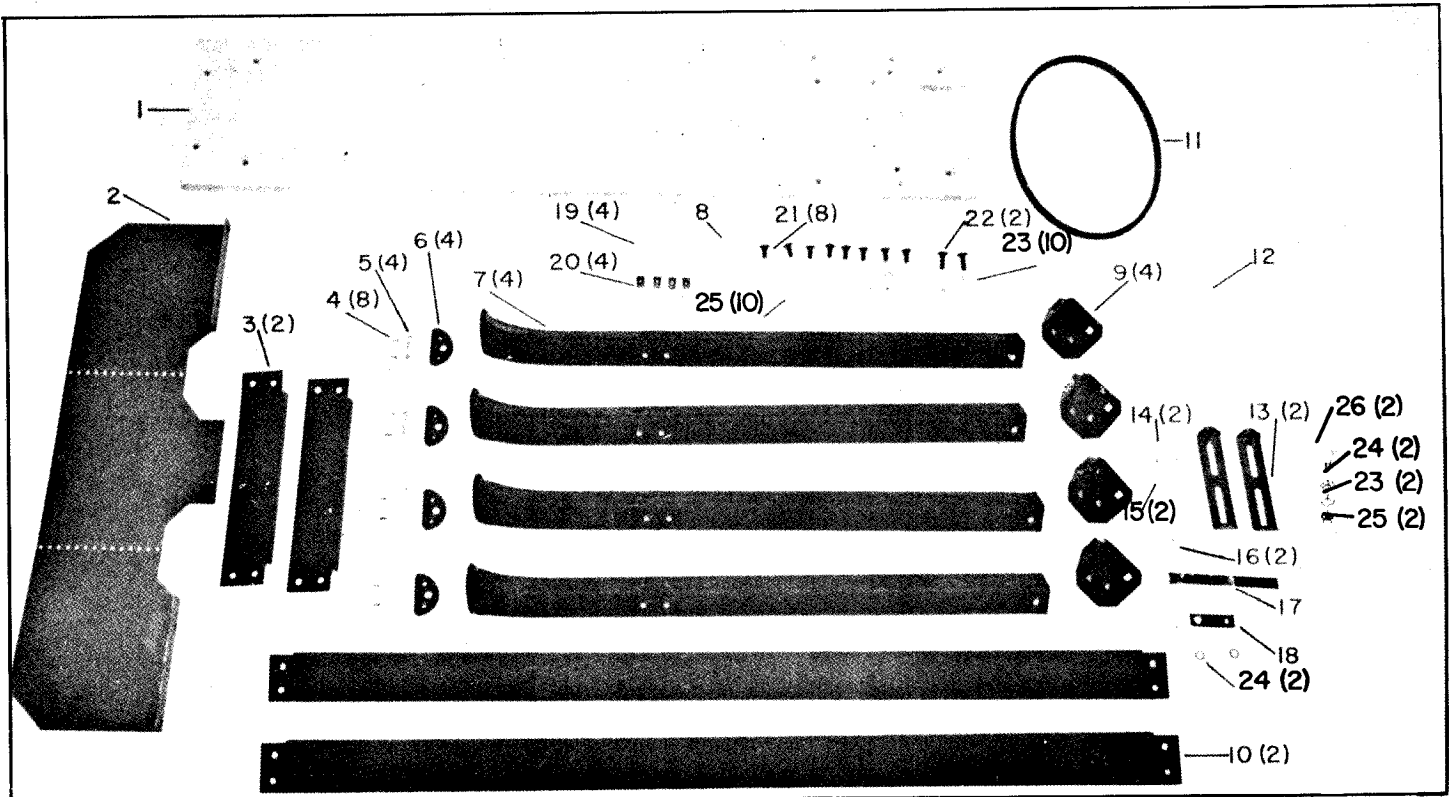

50-151 STAND

Replacement Parts

Ref. No.	Part No.	Description
1	436-01-115-0074	Wood Shelf
2	436-01-054-0008	Belt & Pulley Guard
3	1087644	Tie Bar 12-1/2" Lg.
*	50-353	Rubber Ft. for stand, Const. Of:
4	901-02-010-0560	#10-32 X 7/16" RHS
5	436-02-079-0001	Retainer
6	436-02-048-0003	Foot
7	436-02-066-0020	Leg
8	424-01-014-0002	Switch Guard
9	1086901	Corner Bracket
10	1087627	Tie Bar 47-1/2" Lg.
11	49-303	V-Belt
12	Bag Ass'y.	For Assembling Stand, Const. Of:
*	901-02-030-0408	5/16-18 X 3/4" Flat Hd. Scr. (24 pcs.)
*	902-01-010-1300	5/16"-18 Hex Nut (24 pcs.)
13	1087211	Bracket
14	901-01-060-0606	5/16-18 X 5/8" HHCS
15	904-02-010-1703	5/16" Lockwasher
16	902-01-010-1300	5/16"-18 Hex Nut
17	1087543	Strip of 8 Rubber Bumpers
18	436-01-072-0009	Grounding Strap
19	901-05-430-3026	#8 X 3/4" Self-Tapping Scr.
20	902-03-000-2953	Tinnerman Nut
21	901-11-020-0808	5/16-18 X 1" Carriage Bolt
22	901-11-020-0830	5/16-18 X 1-1/4" Carriage Bolt
23	904-01-010-1604	Washer
24	904-03-030-1656	5/16" Ext. Both Lockwasher
25	902-01-010-1300	5/16"-18 Hex Nut
26	901-11-020-0834	5/16-18 X 3/4" Carriage Bolt

* NOT SHOWN