

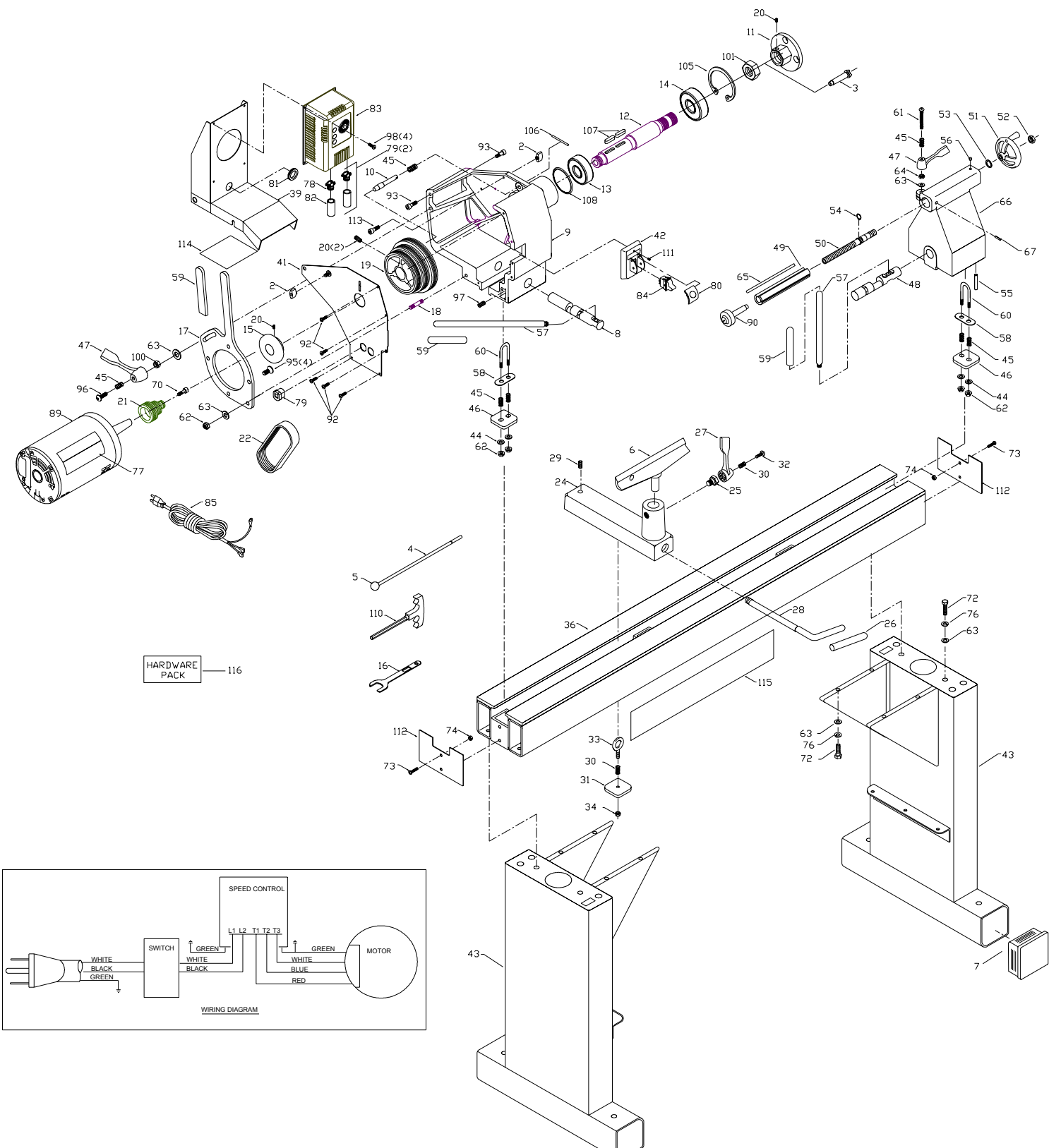

46-745
46-746 & 46-765X
16" WOOD LATHE

WL-12

PART NO. 434-10-651-0009
DATE: 01-29-04



REPLACEMENT PARTS

Ref.	No.	Part No.	Description	Ref.	No.	Part No.	Description
	2	422-39-138-0007	KNOB		60	434-10-111-0001	3/8-16 U-BOLT
	3	1340946	DRIVE CENTER, INCL.:		61	901-03-043-1841	BOLT
		1340945	CENTER POINT		62	902-01-213-1838	NUT
	4	746905	KNOCKOUT BAR, INCL.:		63	904-01-010-1615	WASHER
	5	931-01-021-4099	KNOB		64	902-01-040-1026	NUT
	6	46-711	TOOL REST 12"		65	434-10-132-0002	TAILSTOCK SCALE
	7	434-10-020-0001	CAP		66	434-10-092-0001	TAILSTOCK
	8	434-10-042-0004	HEADSTOCK ECCENTRIC		67	905-01-010-2729	3/16" X .5" ROLL PIN, CMO
	9	434-10-358-0003	HEADSTOCK			905-01-011-9301	3/16" X .375" ROLL PIN, EMO
	10	434-10-071-0004	INDEX PIN STOP		70	901-03-043-1840	SCREW
	11	434-10-072-0001	FACE PLATE 4" 1 1/4		72	901-01-060-0640	BOLT
	12	434-10-085-0001	SPINDLE		73	901-03-040-8015	BOLT
	13	434-10-626-0001	BEARING		74	902-01-133-1529	NUT
	14	434-10-626-0002	BEARING		76	904-02-020-1704	WASHER
	15	434-10-400-0002	HAND WHEEL, INCL.: REF. 20		77	434-10-754-0001	WARNING LABEL
	16	434-10-101-0001	WRENCH 1 3/4		78	438-01-004-0007	CLAMP
	17	434-10-102-0002	MOTOR YOKE		79	438-01-004-0069	STRAIN RELIEVER
	18	434-10-112-0002	SCREW		80	422-39-067-0001	SAFETY SHUT OFF
	19	434-10-430-0001	PULLEY, INCL.:		81	438-01-011-0051	GROMMET
	20	901-04-150-0231	5/16 X 18 X 3/8" SCREW		82	438-01-011-0054	SLEEVE
	21	434-10-430-0002	PULLEY		83	438-01-016-0205	VARIABLE FREQ DRIVE, 46-745
	22	434-10-133-0003	POLY-V BELT			438-01-016-0209	VARIABLE FREQ DRIVE, 46-746 & 46-765X
	**	434-10-305-0003	TOOL REST BASE ASSY (NOTE D), INCL.:		84	438-01-017-0206	SWITCH
	24	434-10-005-0001	TOOL REST BASE		85	438-01-302-0665	CORD, 46-745
	25	434-10-111-0002	SCREW			438-01-302-0403	CORD, 46-746 & 46-765X
	26	434-10-105-0001	SLEEVE , 46-745 & 46-746		89	66-037	MOTOR, 46-745
		434-10-105-0004	SLEEVE , 46-765X			438-02-314-6191	MOTOR, 46-746 & 46-765X
	27	434-08-067-0002	LEVER, 46-745 & 46-746		90	1342071	LIVE CENTER, INCL.:
		434-08-067-0004	LEVER, 46-765X			1340945	CENTER POINT
	28	434-10-019-0001	CAM SHAFT, 46-745 & 46-746		92	901-02-443-1812	8/32 X 1/2" SCREW
		434-10-019-0003	CAM SHAFT, 46-765X		93	901-03-010-0776	BOLT
	29	901-04-293-1395	5/16-18 X 3/4" SET SCREW		95	901-03-030-8007	SCREW
	30	928-01-023-1644	SPRING		96	901-03-043-1841	SCREW
	31	434-10-027-0001	CLAMP - ONE HOLE		97	901-04-150-9428	SET SCREW
	32	901-03-043-1840	SCREW		98	901-05-183-1142	10/32 X 5/8" SCREW
	33	434-03-112-0002	3/8" EYE BOLT		100	902-01-040-1026	NUT
	34	902-01-213-1838	NUT		101	902-01-073-1817	NUT
	36	434-10-306-0004	BED		105	904-15-102-0196	RETAINING RING (NOTE A)
	39	434-10-331-0005	COVER ASSEMBLY		106	905-01-012-0310	ROLL PIN
	41	434-10-331-0006	COVER ASSEMBLY SIDE		107	927-03-010-2695	KEY
	42	438-01-008-0074	SWITCH COVER		108	928-06-021-3393	WASHER
	43	434-10-389-0011	SUPPORT		110	955-03-023-1739	"T" HEX WRENCH
	**	434-10-392-0004	TAILSTOCK ASSY (NOTE D), INCL.:		111	803228	8-32 X 1" SCREW
	44	904-01-010-1605	WASHER		112	434-10-072-0009	BED COVER
	45	928-01-023-1644	SPRING, EMO (NOTE C)		113	901-03-010-3345	1/4 X 20 X 1" SCREW
	46	434-10-027-0002	CLAMP		114	434-10-137-0001	SPEED CHART
	47	434-08-067-0002	LEVER, 46-745 & 46-746		115	434-10-137-0002	BED LABEL, 46-745 & 46-746
		434-08-067-0004	LEVER, 46-765X			434-10-137-0005	BED LABEL, 46-765X
	48	434-10-042-0001	TAILSTOCK ECCENTRIC		116	434-10-628-0004	HARDWARE PACK
	49	434-10-406-0001	TAIL SHAFT				
	50	434-10-112-0004	TAILSTOCK SCREW				
	51	434-10-400-0001	HANDWHEEL ASSY , 46-745 & 46-746				
		434-10-400-0003	HANDWHEEL ASSY , 46-765X				
	52	902-01-021-7801	NUT		**	46-739	FACE SHIELD
	53	904-07-010-5566	FIBER WASHER		**	46-946	8" FACE PLATE
	54	904-15-013-1818	RETAINING RING		**	25-857	LAMP ATTACHMENT
	55	905-01-010-5072	ROLL PIN		**	46-693	42" TOOL REST
	56	907-00-000-2486	COVER		**	46-856	ADJ. SPEED DRIVE MOUNT POST
	57	434-10-067-0001	LEVER , 46-745 & 46-746		**	46-408	TURNING DUPLICATOR
		434-10-067-0004	LEVER , 46-765X		**	46-697	FLOOR STAND
	58	434-10-072-0012	SPRING PLATE - C.F.(NOTE B)		**	46-552	SPINDLE ADAPTOR (NOTE E)
	59	434-10-105-0001	SLEEVE , 46-745 & 46-746		**	50-341	1 1/4 X 8 THREAD TO 1 X 8 THREAD
		434-10-105-0004	SLEEVE , 46-765X				MOBILITY KIT

ACCESSORIES: (Optional)

SERVICE NOTE

- A:** Ref. 105 must be installed with flat side facing race of bearing Ref. 14
- B:** It has been determined that this plate is not necessary and it has been eliminated. Discard when performing repairs.
- C:** It has been determined that Spring Reference 45 is not needed and it has been eliminated. When performing repairs insure that Nuts Reference 62 are properly adjusted and discard Springs.
- D:** These assemblies supplied in 46-745/46-746 colors only, they can be used on the 46-765X.
- E:** 46-552 adapter has 1 X 8 external thread so that chucks with this thread can be used on this lathe.

STANDARD SAFETY EQUIPMENT

In order to promote tool safety, Delta Machinery strictly enforces the policy of repairing or replacing any damaged or missing standard safety equipment on machines presented to Delta Authorized Service Centers for service/repairs. Any product that is presented to a Delta Authorized Service Centers for repairs which contains missing or damaged standard safety equipment will have that equipment repaired or replaced and the customer will be charged for any such service/repairs. Customers can avoid such charges only if the missing safety component is supplied to the service center at the time of repair.

This parts list is provided to aid in obtaining service parts. Copies of the instruction and maintenance literature can be obtained through the Delta Technical Publications Department or through your service outlet.