



# 34-897 UNIFENCE 34-899 AUX. TABLE FOR UNIFENCE

CS-4K-5

422-27-655-0004

Revised 8-15-85

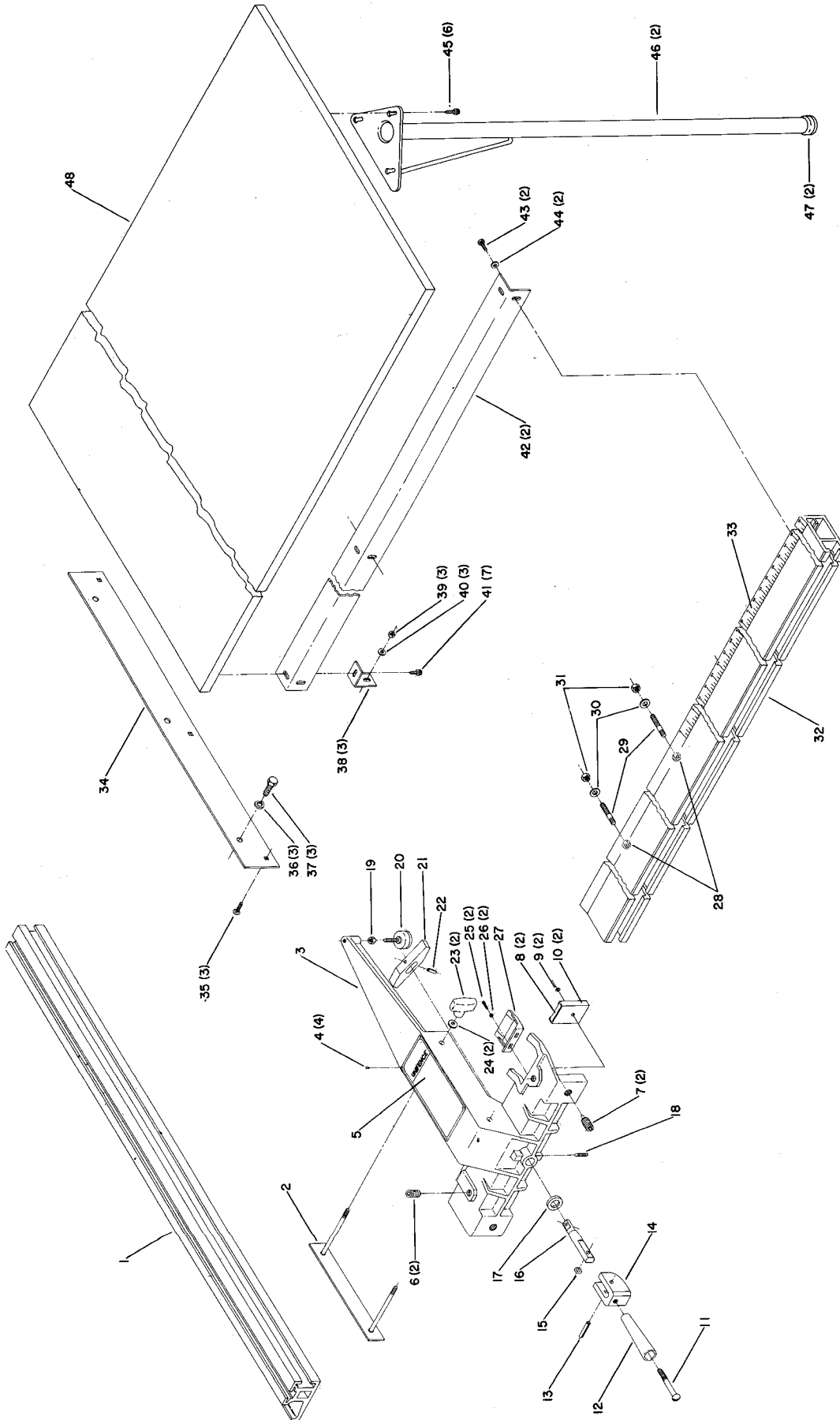

## REPLACEMENT PARTS

REF. NO.	PART NO.	DESCRIPTION
*	34-897	Unifence, Const of:
1	34-894	43" Fence
2	400-06-327-0001	Clamp Assembly
3	400-06-312-0001	Fence Body Assy., Incl: (See Service Note A)
4	901-06-450-2250	#4 x 3/16" Drive Screw
5	422-27-137-0002	Nameplate
6	422-27-112-0004	Nylon Screw (Current Models Only)
7	422-27-112-0003	Slide Adjusting Screw
8	400-06-384-0002	Adjustable Slide Assy., Incl:
9	422-27-079-0001	Retainer
10	422-27-084-0006	Nylon Slide (Current Models Only, See Service Note A)
11	1087658	5/16 x 2 1/2" Rd Hd Screw
12	1087659	Handle
13	905-01-103-1370	Coiled Spring Pin
14	422-27-019-0002	Cam
15	928-05-013-1371	Wave Washer (Early Models Only)
16	422-27-106-0003	Control Shaft
17	422-27-104-0002	Thrust Washer
18	422-27-112-0002	Spring Plunger
19	902-01-010-1300	5/16-18 Hex Nut
20	422-27-048-0001	Foot, Rear Support
21	422-27-068-0003	Locking Lug
22	905-01-010-2702	1/4 x 5/8" Roll Pin
23	424-12-060-0003	Knob
24	904-01-010-1620	11/32" Washer
25	901-02-050-5634	#6-32 x 1/2" Fillister Hd. Scr.
26	904-01-043-1370	#6 Washer, Type B
27	400-06-375-0001	Cursor
28	902-01-010-1207	3/8-24 Hex Nut
29	422-27-111-0003	Stud
30	904-01-010-1615	13/32" Washer
31	902-01-010-5900	3/8-16 Hex Nut
32	422-27-055-0003	Front Guide Rail, Incl:
33	400-06-432-0001	Scale
34	422-27-001-0001	Adapter
35	901-11-020-0821	1/4-20 x 3/4" Carriage Bolt
36	904-02-010-1716	7/16" Lockwasher
37	901-01-060-0664	7/16-20 x 1" Hex Hd Cap Screw
38	422-27-089-0007	Angle Bracket
39	902-01-120-1034	1/4-20 Hex Nut
40	904-01-010-1614	9/32" Washer
41	901-06-223-1380	#14 x 3/4" Slot. Hex, Washer Face, Type AB Screw
42	422-27-089-0006	Table Support
43	901-01-060-0612	1/4-20 x 5/8" Hex Hd Cap Screw
44	904-01-010-1614	9/32" Washer
45	901-06-223-1380	#14 x 3/4" Slot Hex, Washer Face, Type AB Screw
46	422-27-066-0001	Leg, Incl:
47	422-27-412-0001	Foot
48	34-899	Table
**	400-06-384-0001	Bearing Pad Kit (Early Models Only, See Service Note A)
**	955-03-010-0006	1/4" Allen Wrench

\* NOT SHOWN ASSEMBLED  
 \*\* NOT SHOWN

### SERVICE NOTES

A - Bearing pad replacement kit (Part No. 400-06-384-0001) is available for early models with glued on Teflon bearing pads. This kit includes two (2) bearing pads and instructions. Replacement of all the bearing pads on the unifence requires three (3) kits.