

# REPLACEMENT PARTS

REF NO	PART NUMBER	DESCRIPTION	REF NO	PART NUMBER	DESCRIPTION
1	901-02-403-1131	1/4-20 X 7/8" TRUSS HD SCREW (See Service Note A)	41	901-03-010-0229	1/4-20 X 1/2" HEX SOC HD SCREW
2	904-01-010-1620	FLAT WASHER	42	904-02-020-1702	1/4" LOCK WASHER
3	1346805	STOP	48	1346790	BUSHING
4	1346813	HANDLE	49	1346791	BLOCK
5	904-01-010-1620	FLAT WASHER	50	1344952	(DIN 7981B) M4.2 X 16MM PAN HD SCREW
6	1346804	BRACKET	51	904-02-020-1702	1/4" LOCK WASHER
7	1346806	POINTER	52	1344891	1/4-20 X 3/4" BUTTON HD SCREW
8	1246000	(DIN 84) M3 X 6MM CHEESE HD SCREW	53	901-04-150-0235	#10-24 X 3/8" HEX SOC SET SCREW
9	1346803	NUT	54	1347507	SLIDE
10A	1346818	METRIC SCALE	54A	1347506	SPACER
10B	1346809	SCALE	54B	1347518	SPECIAL BOLT
10	1346802	FENCE	55	1346798	BLOCK
11	1347507	SLIDE	56	902-01-120-1034	1/4-20 HEX NUT
11A	1347503	NYLON WASHER	57	901-01-060-0623	1/4-20 X 1" HEX HD SCREW
11B	1347516	SPECIAL BOLT	58	901-04-150-0235	#10-24 X 3/8" HEX SOC SET SCREW
12	1347504	SPACER	59	1346789	ROD
13	1346793	BUSHING	60	1346801	BRACKET
14	901-03-010-0770	5/16-18 X 1 1/4" HEX SOC HD SCREW	61	904-01-031-6202	FLAT WASHER
15	904-02-010-1703	5/16" LOCK WASHER	62	1346812	HANDLE
16	1346776	RAIL	63	904-02-020-1704	3/8" LOCK WASHER
16A	1346814	CAP	64	902-01-040-1026	3/8-16 HEX NUT
17	1346816	7/16-20 X 2 1/2" HEX SOC HD SCREW	65	901-03-010-0229	1/4-20 X 1/2" HEX SOC HD SCREW
17A	904-02-010-1716	7/16" LOCK WASHER	66	904-02-020-1702	1/4" LOCK WASHER
18	1346777	BAR	67	1346781	BRACKET
19	400-06-048-0001	FOOT	68	904-01-031-6202	FLAT WASHER
20	904-01-010-1609	FLAT WASHER	69	1346811	HANDLE
21	901-02-163-1002	#10-24 X 1" PAN HD SCREW	70	1346810	(DIN 1481) M3 X 38MM SPRING PIN
22	901-04-150-0235	#10-24 X 3/8" HEX SOC SET SCREW	71	1346782	HANDLE
23	1346795	BRACKET	72	1346780	BRACKET
24	1346797	PIN	73	902-01-010-1282	1/2-13 HEX NUT
24A	1346820	O RING	74	904-02-020-1705	1/2" LOCK WASHER
25	905-01-010-2719	1/8" X 1" SPRING PIN	75	1346794	BRACKET
26	1243503	EXT RET RING	76	1341948	M15 FLAT WASHER
27	400-08-139-0011	BALL BEARING	77	920-04-022-4021	BALL BEARING
28	1346785	SHAFT	78	1346786	SHAFT
29	904-01-031-6202	FLAT WASHER	79	901-01-060-0626	1/4-20 X 3/4" HEX HD SCREW
30	1347505	HANDLE	80	902-01-040-1026	3/8-16 HEX NUT
31	1344952	(DIN 7981B) M4.2 X 16MM PAN HD SCREW	81	904-02-020-1704	3/8" LOCK WASHER
31A	1346807	SCALE	82	904-01-010-1605	3/8" FLAT WASHER
32	1346788	TABLE	83	1347508	STUD
32A	1346817	TABLE DECAL	84	1346779	SUPPORT
33	902-01-210-1072	5/16-18 LOCK NUT	85	1346778	GUIDE BAR
34	428-06-017-0004	BALL BEARING	86	1346815	CAP
35	1346783	ROLLER	87	902-01-010-1300	5/16-18 HEX NUT
36	428-06-017-0004	BALL BEARING	88	904-01-010-1604	5/16" FLAT WASHER
37	1346784	SHAFT	89	1346819	M8.5 SPECIAL WASHER
38	1346787	FRAME	90	904-01-010-1604	5/16" FLAT WASHER
39	904-02-020-1704	3/8" LOCK WASHER	91	901-01-060-0649	5/16-18 X 1" HEX HD SCREW
40	902-01-040-1026	3/8-16 HEX NUT	95	1330154	2MM HEX WRENCH
			95	428-07-101-0002	6MM HEX WRENCH

**SERVICE NOTES:**

A - When servicing screw, retaining compound must be used for reassembly to assure adjustment.

# REPLACEMENT PARTS

## AVAILABLE AS ACCESSORIES

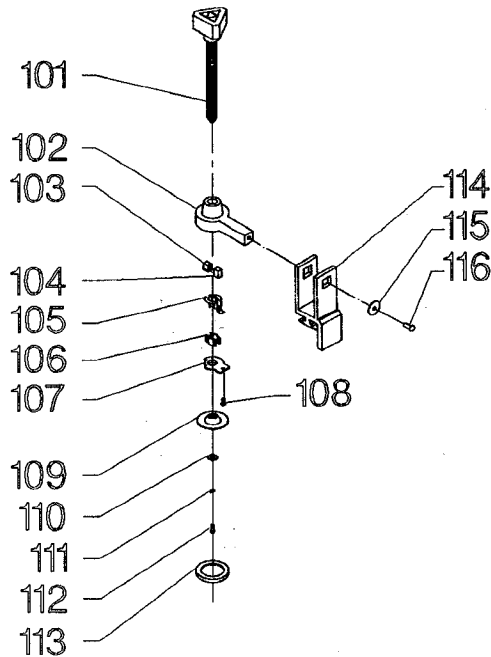

REF NO	PART NUMBER	DESCRIPTION
*	34-556	WORK CLAMP, CONST OF;
101	1343066	SCREW
102	1343067	SUPPORT
103	1343068	LEFT BLOCK
104	1343069	RIGHT BLOCK
105	1343070	BRACKET
106	1343071	CLAMP
107	1343072	SUPPORT COVER
108	1341235	(DIN 84) M4 X 12MM CHEESE HD SCREW
109	1342915	CUP
110	1343545	(DIN 125) M4.1 FLAT WASHER
111	1243525	(DIN 7980) M4.1 LOCK WASHER
112	1310162	(DIN 85) M5 X 12MM PAN HD SCREW
113	1342944	RUBBER CAP
114	1346821	BRACKET
115	1246140	(DIN 125) M6.4 FLAT WASHER
116	1310163	(DIN 85) M5 X 16MM PAN HD SCREW
**	34-557	SPECIAL HINGED MOTOR COVER <i>(Required when mounting sliding table attachment to a delta 10" Tilting Arbor Saw.)</i>
**	34-554	STARTER MOUNTING BRACKET <i>(Required when mounting Sliding Table Attachment to a Delta Special Edition Heavy Duty Shaper with a MTD motor,)</i>
*	NOT SHOWN ASSEMBLED	
**	NOT SHOWN	

### STANDARD SAFETY EQUIPMENT

In order to promote tool safety, Delta International Machinery Corp. strictly enforces the policy of repairing or replacing any damaged or missing standard safety equipment on machines presented to Delta Authorized Service Center for service/repairs. Any product which is presented to a Delta Authorized Service Center for repairs which contains missing or damaged standard safety equipment will have that equipment repaired or replaced and the customer will be charged for any such service/repairs. Customers can avoid such charges only if the missing safety component is supplied to the service center at the time of repair.

*This parts list is provided to aid in obtaining service parts. Copies of the instruction and maintenance literature can be obtained through the Delta Technical Publications Department or through your local service outlet.*