

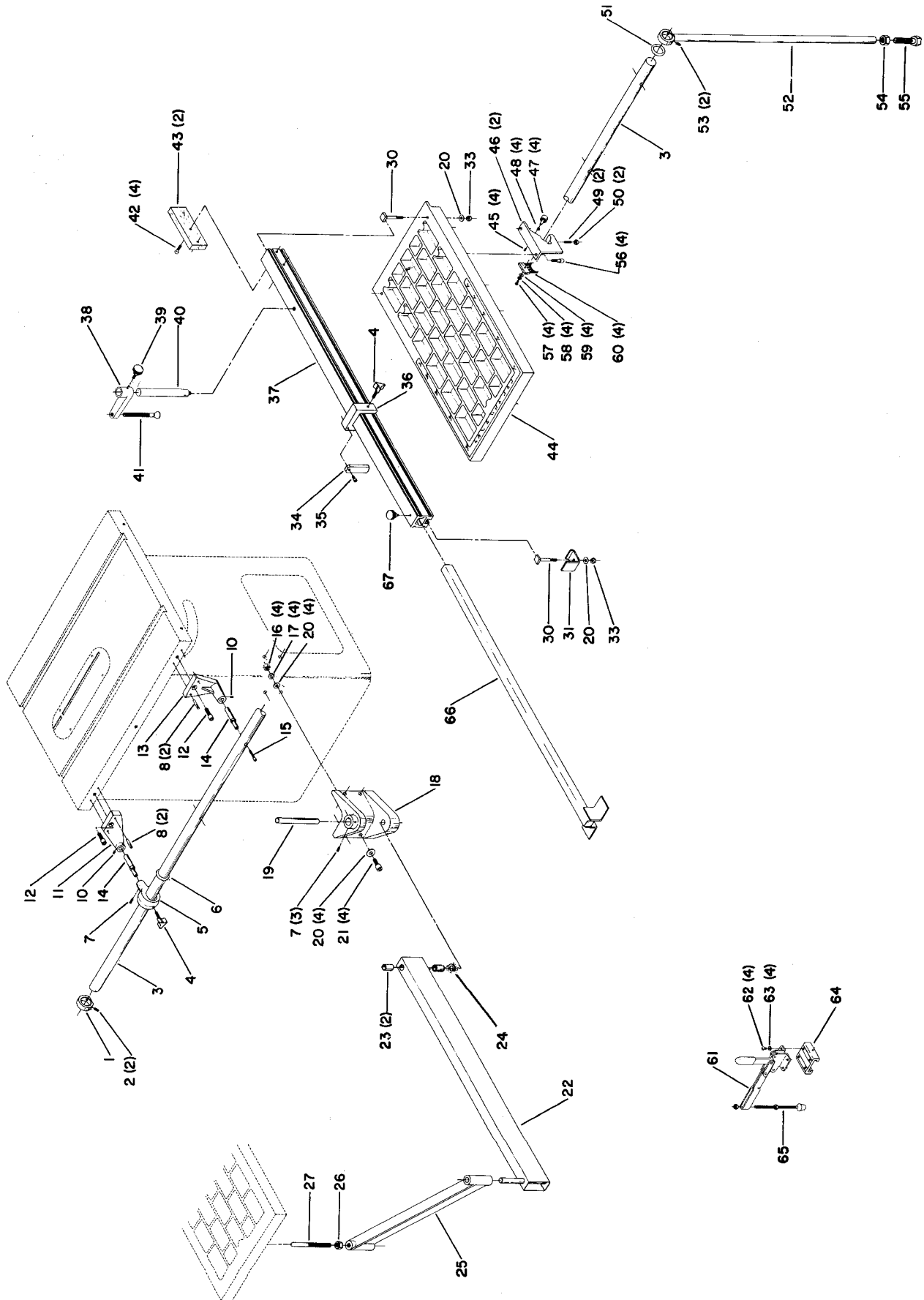

34-485 SLIDING TABLE FOR 10" TILTING ARBOR UNISA

CS-4K-2

422-04-655-5014
DATED 10-15-85



Replacement Parts

Ref. No.	Part No.	Description	Ref. No.	Part No.	Description
1	422-03-060-5004	Stop Collar	39	931-02-113-1171	Hand Knob
2	901-04-150-0217	5/16-18 X 1/2" Soc. Hd. Set Scr.	40	422-04-106-5005	Shaft
3	422-04-106-5006	Rail	41	422-04-090-5001	Swivel Pad Stud
4	931-03-991-9032	Hand Knob	42	901-02-030-0409	5/16-18 X 1-1/4" Flat Hd. Scr.
5	422-04-014-5013	Rail Bracket	43	422-04-104-5016	Chip Breaker
6	908-02-003-1175	O-Ring	44	422-04-091-5002	Sliding Table
7	901-04-190-9449	1/4-20 X 5/8" Soc. Hd. Set Scr.	45	901-04-150-0235	#10-24 X 3/8" Soc. Hd. Set Scr.
8	905-02-010-7105	Groove Pin	46	422-04-014-5015	Brg. Mounting Bracket
10	901-04-190-9415	1/4-20 X 1/4" Soc. Hd. Set Scr.	47	422-04-371-5001	Bearing Assembly, Incl:
11	422-04-014-5017	Rear Rail Mounting Brkt.	48	904-15-010-7035	Retaining Ring
12	901-03-010-3312	7/16-20 X 1" Soc. Hd. Cap Scr.	49	901-04-313-1174	Brass Tip Set Scr.
13	422-04-014-5014	Front Rail Mounting Brkt.	50	902-01-010-1300	5/16-18 Hex Nut
14	422-04-042-5004	Eccentric Pin	51	908-02-003-1175	O-Ring
15	901-03-010-0760	1/4-20 X 1-1/4" Soc.Hd. Cap Scr.	52	422-04-389-5004	Rail Support Ass'y.
16	902-01-020-5433	3/8-16 Hex Jam Nut	53	901-04-150-0217	5/16-18 X 1/2" Soc. Hd. Cap Scr.
17	904-02-020-1704	3/8" Lockwasher	54	902-01-110-1008	3/4-10 Hex Nut
18	422-04-014-5016	Hinge Bracket	55	901-01-060-0638	3/4-10 X 2-1/2" Hex Hd. Scr.
19	422-04-071-5009	Hinge Pin	56	901-03-010-0775	3/8-16 X 1" Soc. Hd. Cap Scr.
20	904-01-010-1606	7/16 X 1 X .083" Washer	57	901-02-010-0525	#10-24 X 1/2" Rd. Hd. Scr.
21	901-03-010-0775	3/8-16 X 1" Soc. Hd. Cap Scr.	58	904-02-020-1725	#10 Lockwasher
22	422-04-309-5002	Pivot Arm Ass'y., Incl:	59	904-01-010-1603	1/4 X 9/16 X 3/64" Washer
23	920-75-010-7329	Sleeve Bearing (See A)	60	422-23-113-5001	Wiper
24	920-76-023-1173	Thrust Bearing			
25	422-23-089-5003	Small Support Arm	NOT INCLUDED WITH BASIC UNIT		
26	902-01-010-5446	5/8-11 Hex Nut	*	34-488	Clamp Attachment, Const. Of:
27	422-04-112-5010	Adjusting Scr.	61	422-04-027-5005	Toggle Clamp
30	901-11-511-2955	T-Bolt	62	901-02-010-0520	5/16-18 X 3/8" Rd. Hd. Scr.
31	422-04-027-5004	Clamp	63	904-02-010-1703	5/16" Lockwasher
33	902-01-020-1270	3/8-24 Hex Jam Nut	64	422-04-084-5001	Slide
34	422-04-067-5002	Lever	65	422-04-090-5002	Swivel Pan w/Stud
35	901-03-061-2470	Shoulder Set Scr.	66	34-489	Fence Ext., Incl:
36	422-04-027-5007	Stop	67	931-02-113-1171	Hand Knob
37	422-04-043-5004	Fence			
38	422-04-027-5006	Clamp	*	NOT SHOWN ASSEMBLED	

SERVICE NOTE:

A Replacement Sleeve Bearing should be reamed to 3/4".