

REPLACEMENT PARTS

Ref.			Ref.		
<u>No.</u>	<u>Part No.</u>	<u>Description</u>	<u>No.</u>	<u>Part No.</u>	<u>Description</u>
1	OPTIONAL	6" X 48" SANDING BELT	72	1243520	M6.1 LOCK WASHER
2	1346378	SUPPORT BRACKET	73	1246140	M6.4 FLAT WASHER
3	1341046	M6 X 8MM CHEESE HD SCREW	74	1346404	PLATE
4	1346377	RETAINER	75	1243496	M10 HEX NUT
5	1313124	M32 WAVE WASHER	76	1243413	M10 X 40MM HEX SOC SET SCREW
6	1086894	BALL BEARING	77	1243494	M10 X 12MM HEX SOC SET SCREW
7	1243407	EXT RET RING	78	1341544	GROMMET
8	1346375	DRIVE SHAFT	79	902868	BASE
9	1346373	GRAPHITE PAD	80	902733	WARNING LABEL ,T2
10	1243494	M10 X 12MM HEX SOC SET SCREW		1347916	WARNING LABEL ,T1
11	1346369	DRIVE DRUM ASSY	82	1347209	BUMPER
12	1243407	EXT RET RING	83	1246104	M6 X 25MM HEX SOC HD SCREW
13	1086894	BALL BEARING	84	1243520	M6.1 LOCK WASHER
14	1346368	BEARING HOUSING	85	1246140	M6.4 FLAT WASHER
15	1346366	TRUNNION	86	1342697	M6 SQUARE NUT
16	1246157	M8.1 LOCK WASHER	87	1346394	MOTOR BRACKET
17	1346365	SPECIAL SCREW	88	1246026	EXT RET RING
18	1346367	BEARING RETAINER	89	1346393	ROD
19	1243520	M6.1 LOCK WASHER	90	1346392	MOTOR ASSY
20	1246104	M6 X 25MM HEX SOC HD SCREW	90A	438-01-007-0042	WIRE NUT
21	1243494	M10 X 12MM HEX SOC SET SCREW	90B	1346406	JUMPER WIRE
22	1346363	PULLEY	90C	1346407	JUMPER WIRE
22A	1346364	DRIVE BELT	91	1346405	POWER CORD
23	902743	ROTATION LABEL ,T2	91A	1346408	T-WRENCH 6MM X 108MM
	1347919	ROTATION LABEL ,T1	92	1346391	DUST COVER
24	1243520	M6.1 LOCK WASHER	92A	1246088	M5 X 6MM CHEESE HD SCREW
25	1246140	M6.4 FLAT WASHER	93	1346395	MOTOR PULLEY
26	1346361	M6 X 55MM HEX SOC HD SCREW	94	1243494	M10 X 12MM HEX SOC SET SCREW
27	1243494	M10 X 12MM HEX SOC SET SCREW	95	1342455	M5 X 10MM PAN HD SCREW
29	1346360	DISC PLATE	96	1310547	M4.2 X 12MM PAN HD SCREW
30	1346359	KEY	97	n 1343759	SWITCH, INCL;
31	OPTIONAL	9" SANDING DISC	98	400-06-068-0002	SWITCH KEY
32	1246164	M4.2 X 13MM PAN HD SCREW	99	902731	NAMEPLATE ,T2
33	1346357	DISC COVER		1347921	NAMEPLATE ,T1
34	1345156	PLUG	100	902354	UNIT HARDWARE PACK
35	1346362	BELT COVER	101	1347694	M4.2 X 25MM PAN HD SCREW
36	1246104	M6 X 25MM HEX SOC HD SCREW	102	1341563	RELAY
37	1243520	M6.1 LOCK WASHER	103	1225324	CAPACITOR
38	1346372	FRAME	104	1346396	SWITCH BOX
38A	902723	TIGHTEN LABEL ,T2	105	1343644	BUSHING
	1347918	TIGHTEN LABEL ,T1	106	1243561	M10 X 25MM HEX SOC HD SCREW
38B	902725	DIRECTION LABEL ,T2	107	1243360	M10.2 LOCK WASHER
	1347920	DIRECTION LABEL ,T1	108	1243502	M10 FLAT WASHER
39	902-01-010-5446	5/8-11 HEX NUT	109	1342455	M5 X 10MM PAN HD SCREW
40	1346374	STOP SCREW	110	1320101	M5.3 EXT TOOTH WASHER
41	1343642	M6 LOCK NUT	111	1246104	M6 X 25MM HEX SOC HD SCREW
43	1346389	BACK STOP	112	1243456	M6 HEX NUT
44	1246140	M6.4 FLAT WASHER	113	1346398	TABLE BRACKET
45	1243520	M6.1 LOCK WASHER	114	1243494	M10 X 12MM HEX SOC SET SCREW
46	1246056	M6 X 12MM HEX SOC HD SCREW	115	1341153	M8 X 12MM HEX HD SCREW
47	1341533	RUBBER WASHER	116	1243526	M8.4 FLAT WASHER
48	1243497	EXT RET RING	117	1346399	TABLE SCALE
49	400-08-139-0008	BALL BEARING	118	n 900227	M6.4 FLAT WASHER
50	1346380	IDLER SHAFT	119	1341555	KNOB
51	1346381	IDLER DRUM COVER	120	902865	TABLE ,T2
52	1346382	IDLER DRUM		1346400	TABLE ,T1
53	400-08-139-0008	BALL BEARING	121	1246088	M5 X 6MM CHEESE HD SCREW
54	1346383	WAVE WASHER	122	1320101	M5.3 EXT TOOTH WASHER
55	1243497	EXT RET RING	123	1341554	POINTER
56	1341533	RUBBER WASHER	124	1246098	M5 X 16MM HEX SOC HD SCREW
57	1343642	M6 LOCK NUT	125	1320101	M5.3 EXT TOOTH WASHER
58	1346386	ADJUSTING RING	126	1246102	M5.3 FLAT WASHER
59	1346384	IDLER BRACKET	127	1341552	SUPPORT
60	1346385	ADJUSTING SCREW	128	1341550	PIN
61	1346387	TENSION SPRING	129	1342455	M5 X 10MM PAN HD SCREW
62	1341542	SLEEVE	130	1246102	M5.3 FLAT WASHER
63	1346388	TENSION LEVER	131	902866	DUST SPOUT ,T2
64	1246140	M6.4 FLAT WASHER		1347215	DUST SPOUT ,T1
65	1243520	M6.1 LOCK WASHER	132	1243494	M10 X 12MM HEX SOC SET SCREW
66	1246070	M6 X 30MM HEX SOC HD SCREW	133	1346401	SUPPORT ROD
67	1246056	M6 X 12MM HEX SOC HD SCREW	134	n 438-01-011-0072	CAP
68	1243520	M6.1 LOCK WASHER			
69	1246140	M6.4 FLAT WASHER			
70	1346403	DUST GUARD			
71	1246056	M6 X 12MM HEX SOC HD SCREW			

AVAILABLE AS AN ACCESSORY

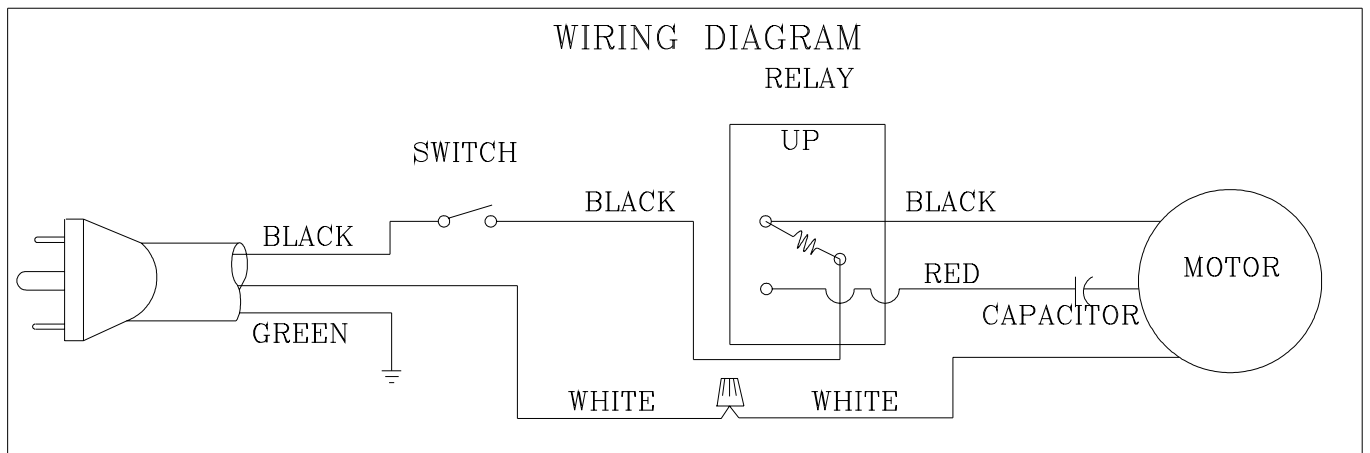
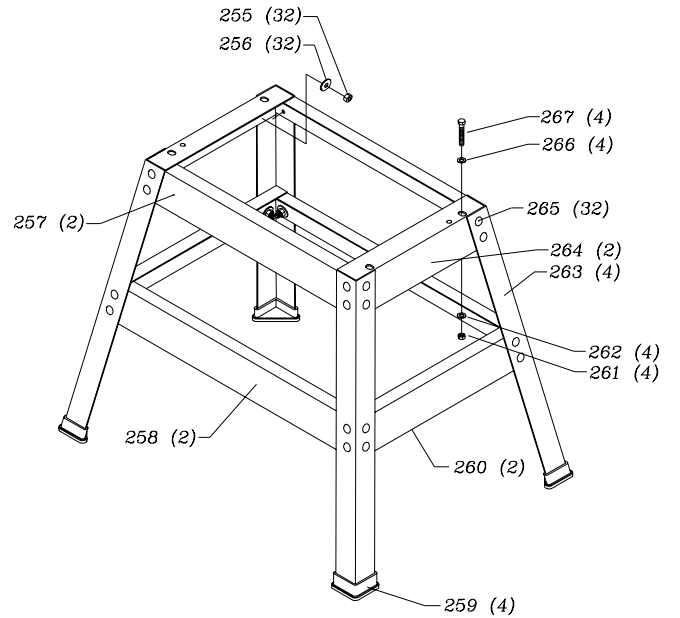
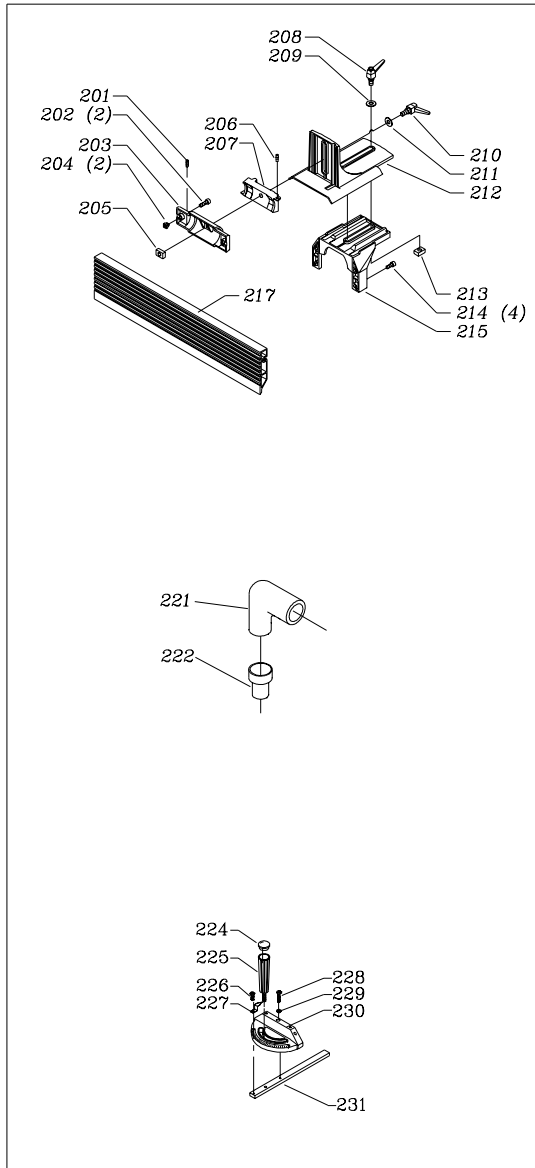

REPLACEMENT PARTS

Ref.	No.	Part No.	Description
*		31-691	FENCE ASSY, CONST OF;
201		1246137	M5 X 8MM HEX SOC SET SCREW
202		1246004	M6 X 16MM HEX SOC HD SCREW
203		1345932	BRACKET
204		1342697	M6 SQUARE NUT
205		1345900	SPECIAL NUT
206		1246137	M5 X 8MM HEX SOC SET SCREW
207		1345933	BRACKET
208		1346370	HANDLE
209		1344330	M8 FLAT WASHER
210		1346371	HANDLE
211		1344330	M8 FLAT WASHER
212		1345902	SLIDE BRACKET
213		1345900	SPECIAL NUT
214		1243336	M6 X 20MM HEX SOC HD SCREW
215	n	906205	FENCE BRACKET
*		31-055	1X30 FLEX SHAFT
217		1346414	FENCE
222		49-220	HOSE ADAPTER
*		34-322	MITER GAGE, CONST OF;
224		422-02-074-0001	HOLE PLUG
225		422-02-060-0003	HANDLE
226		901-05-163-1126	#08-32 X 5/16" PAN HD SCREW
227		1087397	POINTER
228		422-34-112-0002	PIVOT SCREW
229		1086926	SPRING WASHER
230		422-34-050-0001	BODY
231		422-34-004-0001	BAR
*		50-780	STAND FOR 31-780
255		1243398	M8 HEX NUT
256		904-01-010-1606	3/8" FLAT WASHER
257		902872	BRACKET ,T2
		1346409	BRACKET ,T1
258		902871	BRACKET ,T2
		1346410	BRACKET ,T1
259	n	427-99-048-0001	PLASTIC FOOT
260		902870	BRACKET ,T2
		1346411	BRACKET ,T1
261		1243398	M8 HEX NUT
262		904-01-010-1606	3/8" FLAT WASHER
263	n	902873	LEG ,T2
		1346412	LEG ,T1
264	n	902869	BRACKET ,T2
		1346413	BRACKET ,T1
265		1313325	M8 X 20MM CARRIAGE HD SCREW
266		904-01-010-1606	3/8" FLAT WASHER
267		1246192	M8 X 45MM HEX HD SCREW
268		902939	STAND HARDWARE PACK
*			NOT SHOWN ASSEMBLED

STANDARD SAFETY EQUIPMENT

In order to promote tool safety, Delta Machinery strictly enforces the policy of repairing or replacing any damaged or missing standard safety equipment on machines presented to Delta Authorized Service Centers for service/repairs. Any product that is presented to a Delta Authorized Service Centers for repairs which contains missing or damaged standard safety equipment will have that equipment repaired or replaced and the customer will be charged for any such service/repairs. Customers can avoid such charges only if the missing safety component is supplied to the service center at the time of repair.

This parts list is provided to aid in obtaining service parts. Copies of the instruction and maintenance literature can be obtained through the Delta Technical Publications Department or through your service outlet.