

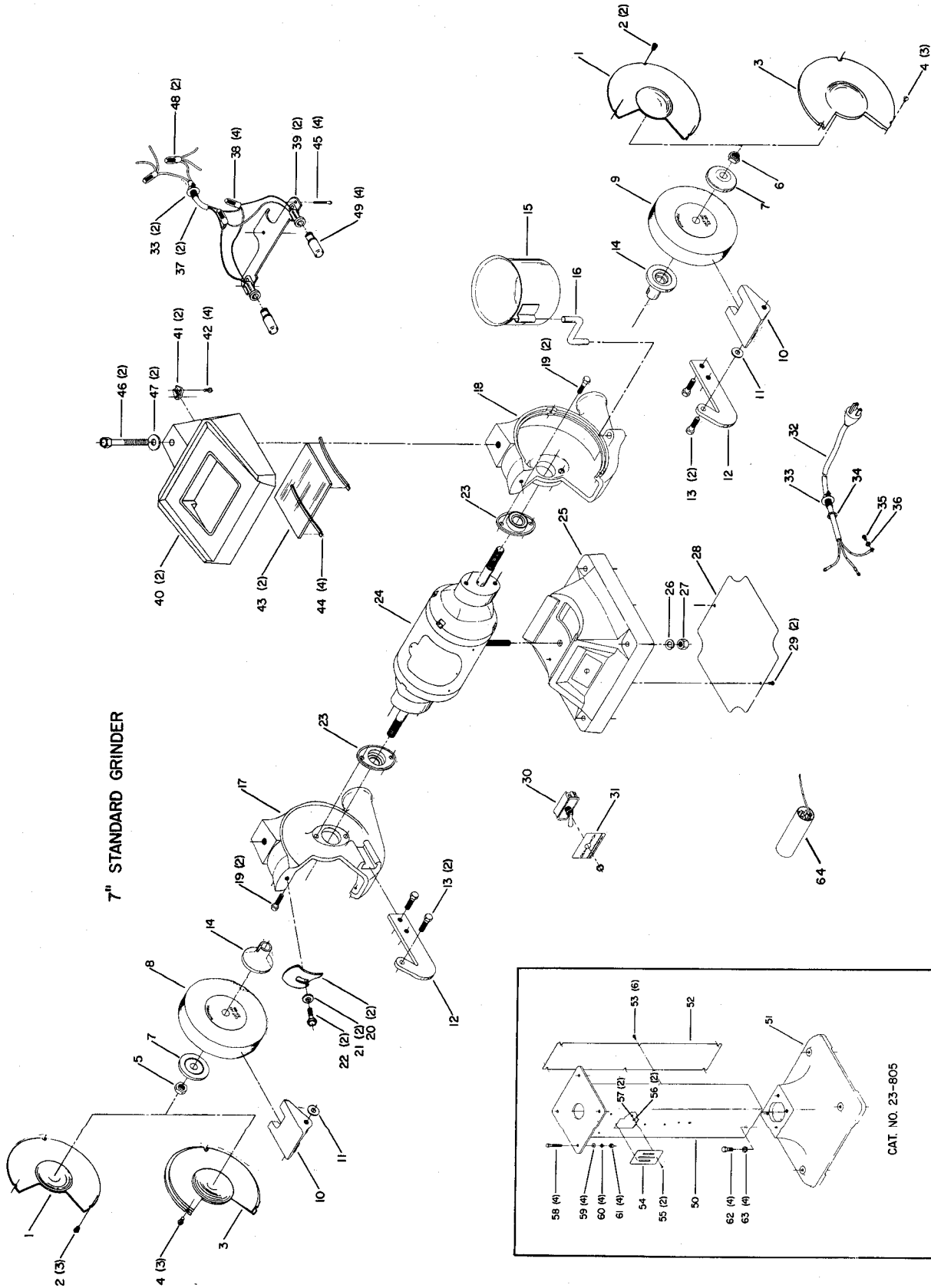

23-200, 23-201, 23-202, 23-206,
23-207, 23-208, 23-209, 23-212,
23-213, 23-214, 23-215
7" STANDARD GRINDER

G-3A

412-01-651-0002
Revised 1-10-86



7" STANDARD GRINDER

CAT. NO. 23-805

Replacement Parts

Ref. No.	Part No.	Description	Ref. No.	Part No.	Description
1	412-01-054-5003	Sheet Metal Guard (See A)	34	438-01-009-0001	1/2" Conduit Locknut
2	901-02-050-0709	#10-32 X 1/4" Fil. Hd. Scr. (For Sheet Metal Guards Only)	35	901-02-010-0548	#10-32 X 1/4" Brass Rd. Hd. Scr.
3	1201296	Cast Iron Guard (See A)	36	904-03-020-1775	#1210-00 Shak. Lockwasher
4	901-02-140-0587	#10-32 X 5/8" Truss Hd. Scr. (For Cast Iron Guards Only)	*	23-025	Twin-Lite Safety Shield, Const. Of:
5	902-01-200-9848	Special Nut	37	438-01-302-0027	Cable, Incl:
6	902-01-201-2571	Special Nut	38	438-01-007-0003	Connector
7	1201295	Flange	39	412-01-331-5002	Socket Ass'y.
8	23-816	Grinding Wheel	40	412-01-054-5006	Guard
9	23-815	Grinding Wheel	41	438-01-004-0022	Clamp
*	412-01-391-5003	Tool Rest Const. Of:	42	901-02-010-0555	#8-32 X 3/8" Rd. Hd. Mach. Scr.
10	412-01-091-5001	Tool Rest	43	412-01-053-5001	Glass
11	904-07-010-5560	Fiber Washer	44	412-01-079-5001	Retainer
12	412-01-014-5002	Bracket	45	901-02-010-0592	#8-32 X 1-1/4" Rd. Hd. Mach. Scr.
13	901-01-060-0658	3/8-24 X 1" Hex Hd. Cap Scr.	46	901-01-060-0675	7/16-20 X 3" Hex Hd. Cap Scr.
14	412-01-103-5005	Flange	47	904-01-031-2925	29/64 X 3/4 X 1/16" Washer
15	412-01-376-5001	Water Pot	48	438-01-007-0003	Connector
16	412-01-014-5001	Bracket	49	23-280	Bulb (Not Included)
17	412-01-054-5005	Guard (Left)	*	23-805	Pedestal, Const. Of:
18	412-01-054-5004	Guard (Right)	50	1201879	Pedestal
19	901-03-010-0750	5/16-18 X 1" Soc. Cap Scr.	51	412-01-005-5002	Base
20	412-01-036-5002	Deflector	52	1201928	Cover
21	904-01-010-1605	3/8 X 7/8 X 1/16" Washer	53	901-02-010-0509	1/4-20 X 1/2" Rd. Hd. Mach. Scr.
22	901-01-060-0663	5/16-24 X 3/4" Hex Hd. Cap Scr.	54	402-04-031-5002	Cover
23	412-01-379-5001	Bearing Seal	55	901-02-010-0553	#6-32 X 1/2" Rd. Hd. Mach. Scr.
24		Motor (See B)	56	904-01-010-1602	3/16" Washer
25	412-01-005-5005	Base	57	902-01-120-9232	Nut
26	904-02-010-1716	7/16" Lockwasher	58	901-01-060-0635	5/16-18 X 2" Hex Hd. Cap Scr.
27	902-01-010-1232	7/16-20" Hex Nut (Incl. w/Motor)	59	904-01-010-1620	11/32 X 11/16 X 1/16" Washer
28	412-01-031-5006	Cover	60	904-02-010-1703	5/16" Lockwasher
29	901-02-010-0551	#10-32 X 1/4" Rd. Hd. Mach. Scr.	61	902-01-010-1300	5/16-18" Hex Nut
30	1225378	Switch	62	901-01-060-0628	1/2-13 X 1" Hex Hd. Cap Scr.
31	438-01-021-0067	Plate	63	904-02-020-1705	1/2" Lockwasher
32	1201141	Cable Ass'y.	64	438-01-029-0005	Capacitor for Single Phase (161-192 M.F.D. 110/115 V.A.C.)
33	438-01-004-0004	Clamp	*	NOT SHOWN ASSEMBLED	

A. Cast Iron Guards and Sheet Metal Guards are not interchangeable.

B. For exact Motor Replacement see Motor Nameplate.