

**FOR USE WITH CURRENT MODELS ONLY**

### REPLACEMENT PARTS

REF NO	PART NUMBER	DESCRIPTION
215	1202149	GEAR RACK (FOR USE WITH 20-661 ONLY)
215	1202157	GEAR RACK (FOR USE WITH 20-761 ONLY)
216	1202148	GEAR
217	905-01-010-5075	1/4" X 3/4" SPRING PIN
218	402-06-013-5002	GEAR BOX
219	1202150	SHAFT
220	904-01-010-1620	FLAT WASHER
221	901-01-060-0609	5/16-18 X 1 1/2" HEX HD SCREW
222	930-05-071-5918	CRANK
223	904-01-031-4993	FLAT WASHER
224	901-01-060-0651	1/4-28 X 1/2" HEX HD SCREW
225	422-04-071-5002	PIN
226	1086395	HANDLE
227	901-01-060-5770	5/16-18 X 2 1/4" HEX HD SCREW
228	901-01-060-0649	5/16-18 X 1" HEX HD SCREW
229	901-04-150-0205	5/16-18 X 1/4" HEX SOC SET SCREW
230	905-02-050-6862	1/4" X 1 1/4" GROOVE PIN
231	1202147	WORM GEAR
232	1202154	THRUST BEARING
233	401-04-089-5002	SUPPORT
234	905-01-010-2730	3/16" X 1 1/2" SPRING PIN
237	901-04-380-4562	GUIDE SCREW
238	902-01-020-5435	5/16-18 JAM NUT
239	921-01-010-0031	STEEL BALL
240	401-04-089-5003	SUPPORT
241	905-04-071-4480	LOCK PLUG
242	901-04-190-6228	1/2-13 X 1/2" HEX SOC SET SCREW

# REPLACEMENT PARTS

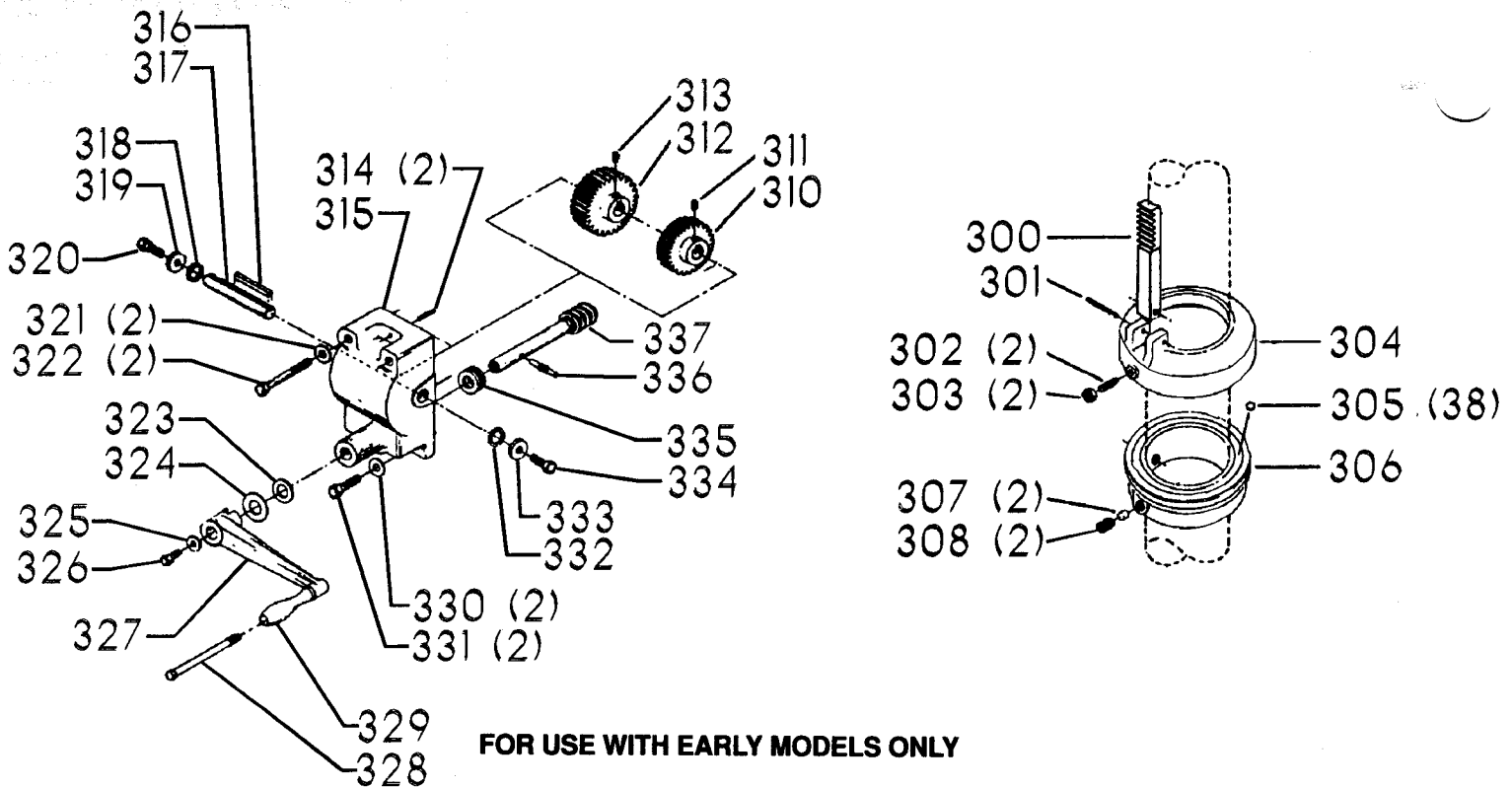

REF NO	PART NUMBER	DESCRIPTION	REF NO	PART NUMBER	DESCRIPTION
300	1200384	RACK (FOR USE WITH 20-761 ONLY)	319	904-10-031-5381	WASHER
300	402-06-051-5005	RACK (FOR USE WITH 20-661 ONLY)	320	901-01-060-0663	5/16-24 X 3/4" HEX HD SCREW
301	905-01-010-2730	3/16" X 1 1/2" SPRING PIN	321	904-01-010-1620	FLAT WASHER
302	901-04-380-4562	GUIDE SCREW	322	901-01-060-5770	5/16-18 X 2 1/4" HEX HD SCREW
303	902-01-020-5435	5/16-18 JAM NUT	323	904-07-071-4214	5/8" WASHER
304	401-04-089-5002	SUPPORT	324	904-01-010-1622	FLAT WASHER
305	921-01-010-0031	STEEL BALL	325	904-01-031-4993	FLAT WASHER
306	401-04-089-5003	SUPPORT	326	901-01-060-0651	1/4-28 X 1/2" HEX HD SCREW
307	905-04-071-4480	LOCK PLUG	327	439-01-067-5002	CRANK
308	901-04-190-6228	1/2-13 X 1/2" HEX SOC SET SCREW	328	422-04-071-5002	PIN
310	401-04-351-5002	GEAR ASSY, INCL:	329	1086395	HANDLE
311	901-04-150-0208	1/4-20 X 1/4" HEX SOC SET SCREW	330	904-01-010-1620	FLAT WASHER
312	401-04-351-5003	GEAR ASSY, INCL:	331	901-01-060-0649	5/16-18 X 1" HEX HD SCREW
313	901-04-150-0208	1/4-20 X 1/4" HEX SOC SET SCREW	332	904-07-071-4230	5/8" WASHER
314	905-02-010-5030	3/16" X 3/4" GROOVE PIN	333	904-10-031-5381	WASHER
315	402-06-013-5001	HOUSING	334	901-01-060-0663	5/16-24 X 3/4" HEX HD SCREW
316	927-03-010-2668	1 3/4" KEY	335	920-52-010-7291	THRUST BEARING
317	401-04-106-5007	GEAR SHAFT	336	905-02-050-6862	1/4" X 1 1/4" GROOVE PIN
318	904-07-071-4230	5/8" WASHER	337	401-04-051-5002	WORM GEAR

## STANDARD SAFETY EQUIPMENT

In order to promote tool safety, Delta International Machinery Corp. strictly enforces the policy of repairing or replacing any damaged or missing standard safety equipment on machines presented to Delta Authorized Service Center for service/repairs. Any product which is presented to a Delta Authorized Service Center for repairs which contains missing or damaged standard safety equipment will have that equipment repaired or replaced and the customer will be charged for any such service/repairs. Customers can avoid such charges only if the missing safety component is supplied to the service center at the time of repair.

*This parts list is provided to aid in obtaining service parts. Copies of the instruction and maintenance literature can be obtained through the Delta Technical Publications Department or through your local service outlet.*